

Dily

h.w. Popřím, I. etapa

MATERIAL: 10.4;
BOD: 1.1.

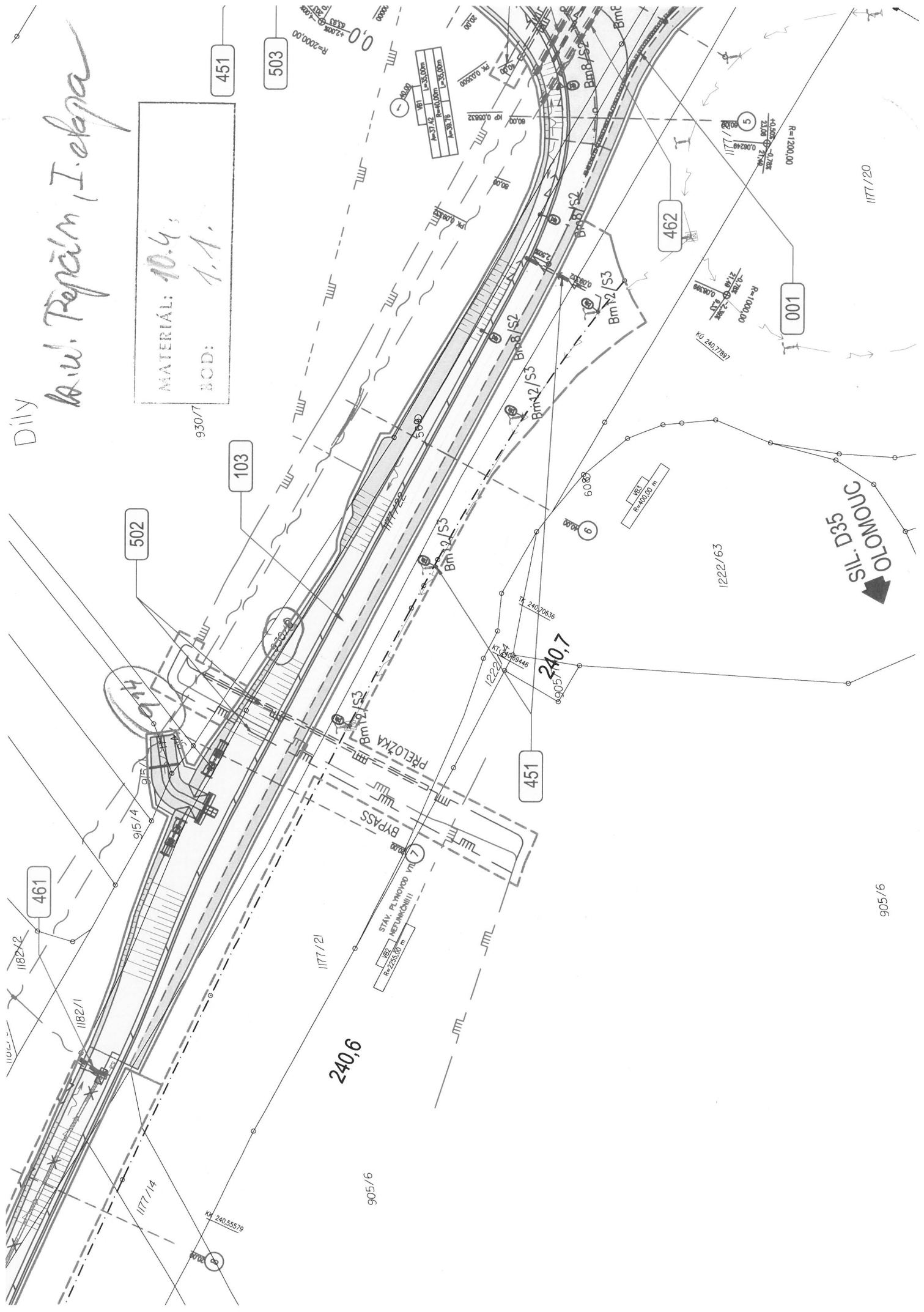

SO 010.1

SO 43

KM 0,050
TRATIČ 2

394/2

PT 0.579753
0.569738
R=400
-1.9%

VYUŠTĚNÍ HORSKÉ PŘÍST. P
DN200, DL 22m, SKLON 2%

MATERIÁL: 10.4.
1.2.
SO 457

h.u. Pospíšil

20.00
KP 0.519753

R=4000
-1.9%
-4%
0.503362

SO 807

394/1

SO 110

394/9

SO 461

1004

KM 0.305-0.503
LEVOSTRANNÝ PŘÍKOP DL 311m

SO 451 PŘELOŽKA STL. PŘI ÚVODU DN200

475/78

475/77

475/76

475/75

475/74

475/73

475/72

475/71

475/70

475/61

1002/14

SO 101

475/60

KADAVNÍ PLÁN
SO 110

VB3	Trasa_01
A	112.25 L 60
R	210
A	112.25 L 60

460/10

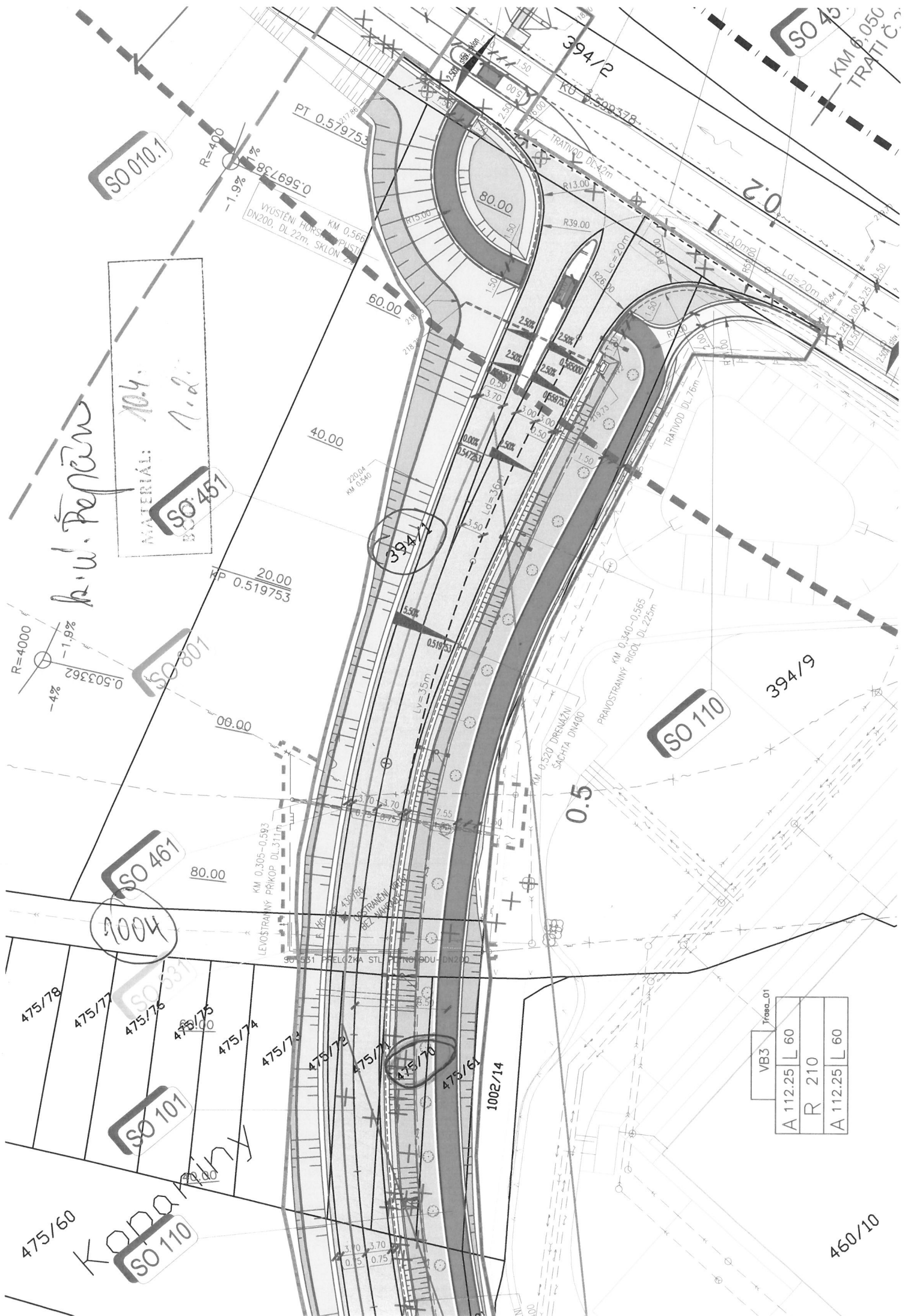

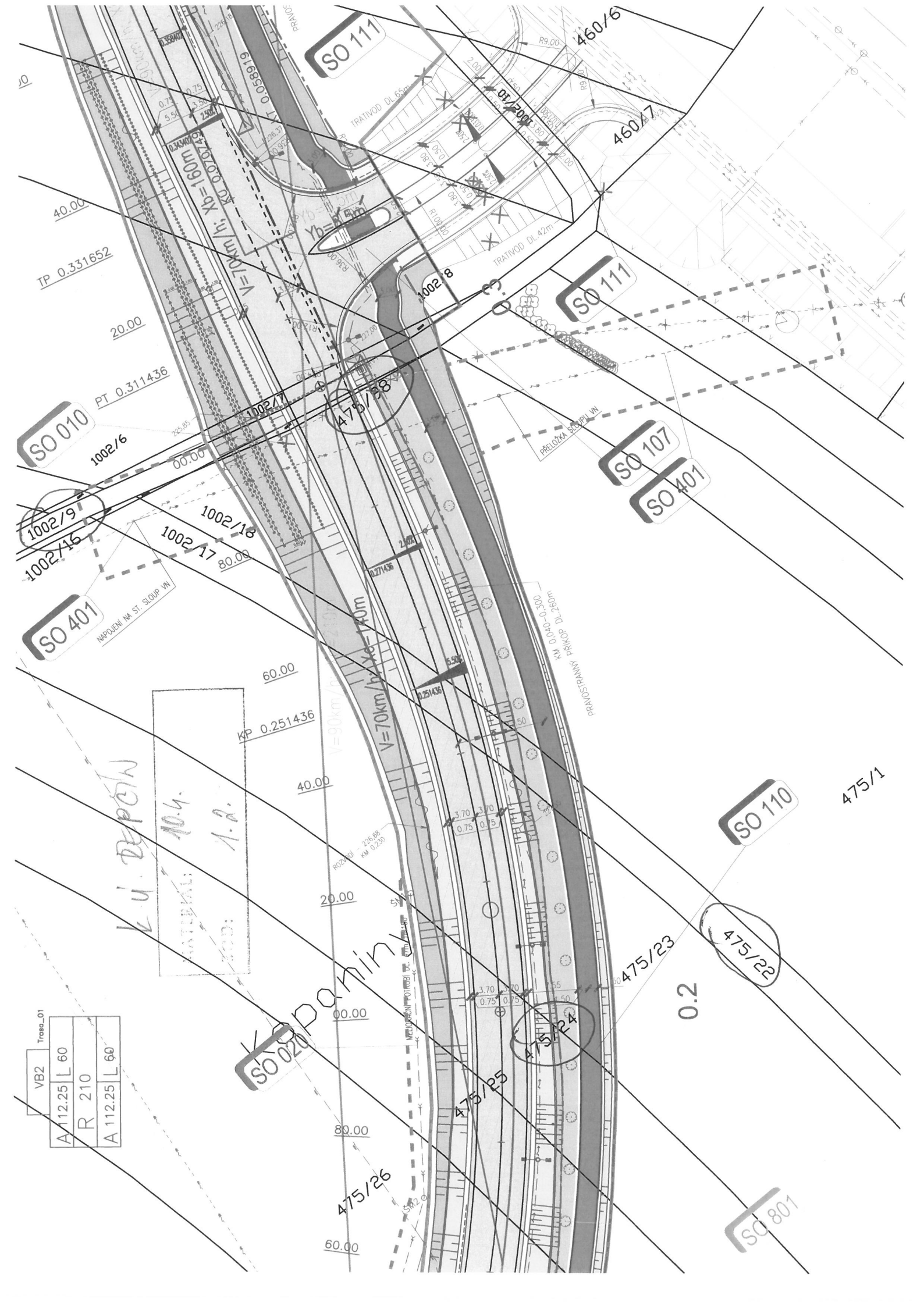

VB2 Trasa_01

A 112.25	L 60
R	210
A 112.25	L 60

L. U. DEPON
 MATERIAL: 10.4
 SLOD: 1.8

KOPANIN

SO 801

SO 110

SO 107
SO 401

SO 111

SO 111

SO 010

1002/9
1002/16

SO 401

475/26

475/25

475/23

475/22

475/1

0.2

TP 0.331652

PT 0.311436

KP 0.251436

20.00

40.00

60.00

80.00

20.00

40.00

10

V=70km/h
Kp=160m
Kp=0.0702129

V=70km/h
Kp=140m

V=90km/h

ROZSAH - 226.88
KM 0.250

PRACOVNANIE PR/KCP DL 2.80m
KM 0.040-0.300

PRELOZKA ST. SLOUP VN

TRATIVOD DL 65m

TRATIVOD DL 42m

460/6

460/7

1002/8

475/18

1002/7

1002/18

1002/17

60.00

40.00

20.00

00.00

80.00

60.00

3.70 3.70
0.75 0.5

3.70 3.70
0.75 0.5

3.70 3.70
0.75 0.5

3.70 3.70
0.75 0.5

3.70 3.70
0.75 0.5

3.70 3.70
0.75 0.5

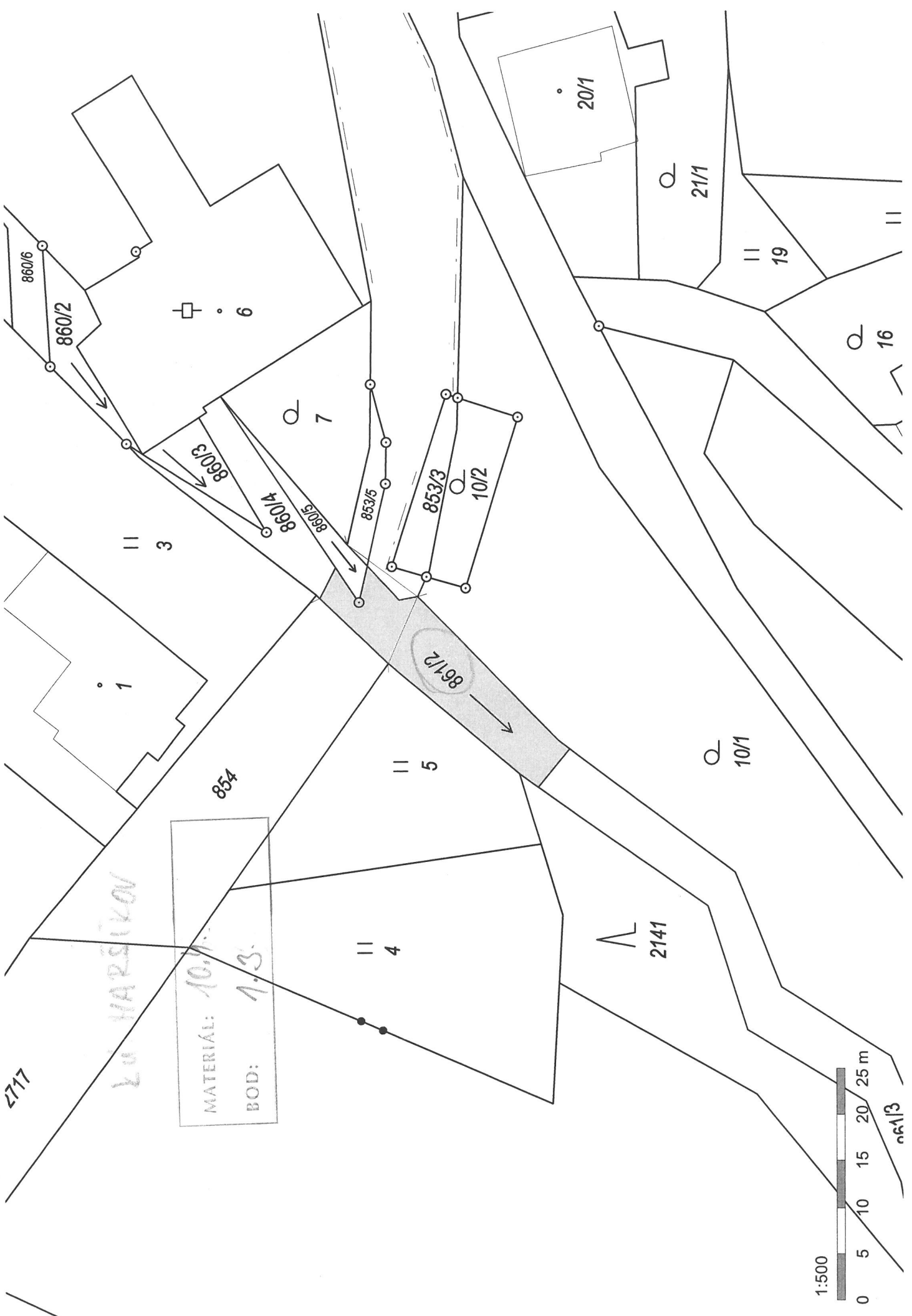

4717

LU HARŠŤKOV

MATERIÁL: 10.7.1
 BOD: 1.3.

854

II 4

II 5

II 3

1

Q 7

86-1/2

Q 10/1

853/3

10/2

860/5

860/4

860/3

860/2

860/6

II 6

Q 16

II 19

Q 21/1

20/1

1:500

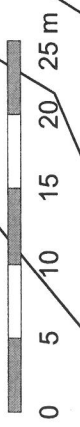

16/13



2141

k.ú. Újezd u Mohelnice

MATERIÁL: 10.4
BOD: 1.4

644/16

15

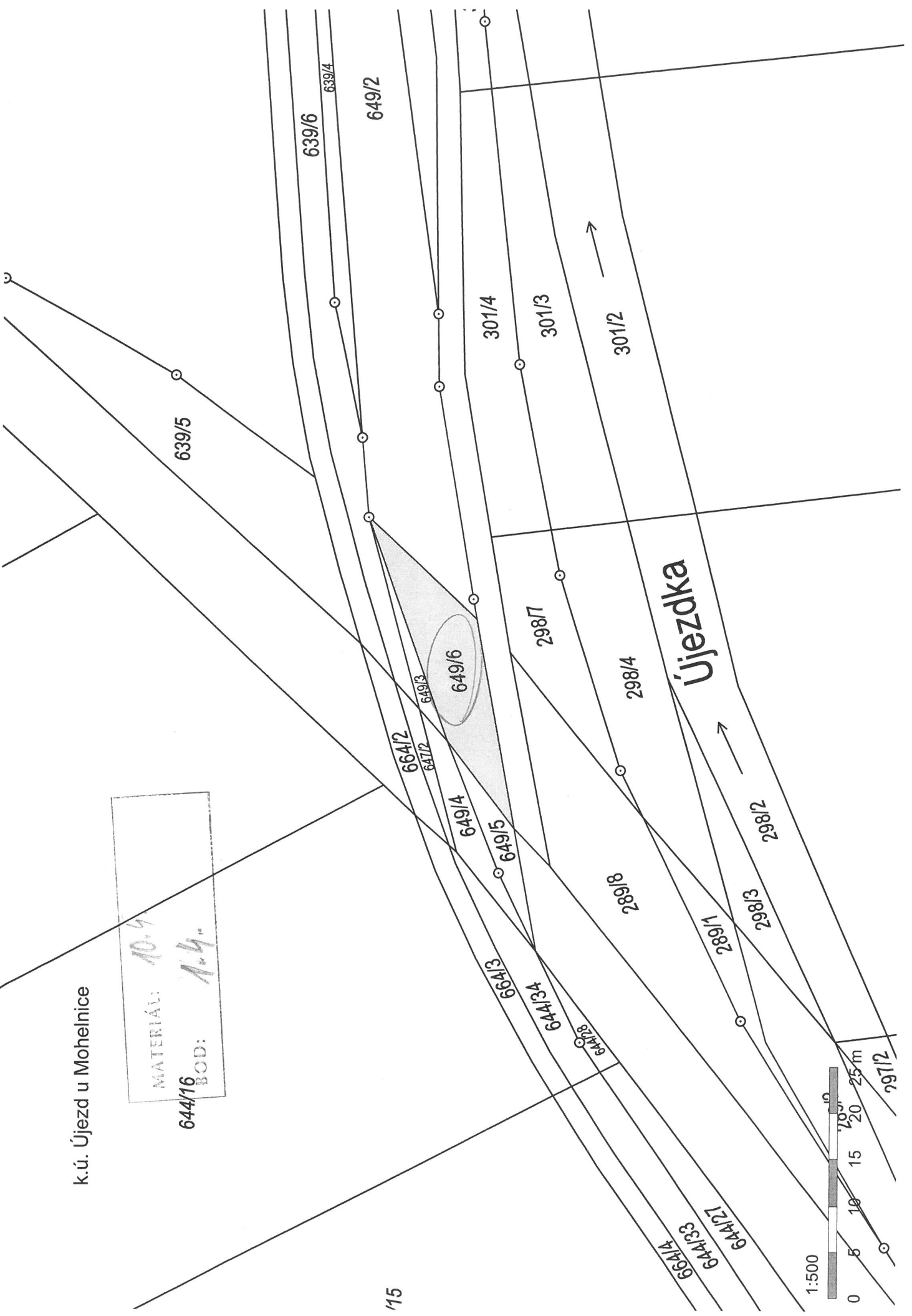

Újezdka

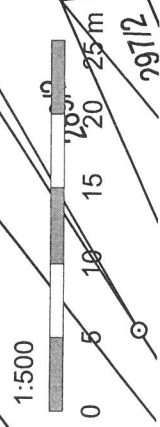

K.ú. SUCHBOL u KONICE

MATERIAL: 10.4.
386
BOD: A.V.



1:250

S.W. Study - 10/1/10

MATERIAL: 10.4.
BOD: 1.6.

343/8

494/21

531/25

531/26

