

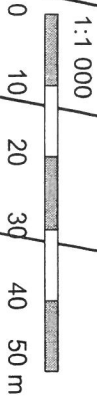

MATERIÁL: 12.11.11
BOD: 0.1.1.3.1.

Močilky

k.ú. Ohrozim



1:1 000

1471/15

345/45

157/63

333

329

157/62

330/2

328/1

157/61

356/3

356/8

325

345/42

157/60

324

345/41

157/59

320

345/40

157/58

328/5

345/39

157/57

345/38

157/56

345/82

328/4

345/37

157/55

1471/23

345/29

345/36

157/54

1471/26

345/24

345/35

157/53

1471/20

345/25

345/34

157/52

1471/19

345/23

345/33

157/37

1471/25

345/26

345/30

157/17

1471/24

345/21

345/20

157/18

1471/27

345/22

345/19

157/19

345/18

508/16

345/17

157/10

508/17

345/16

157/11

508/18

345/15

508/10

535

432/1

54

KN

004.



KN
574.

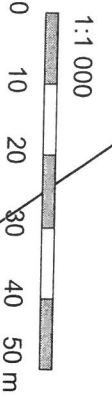
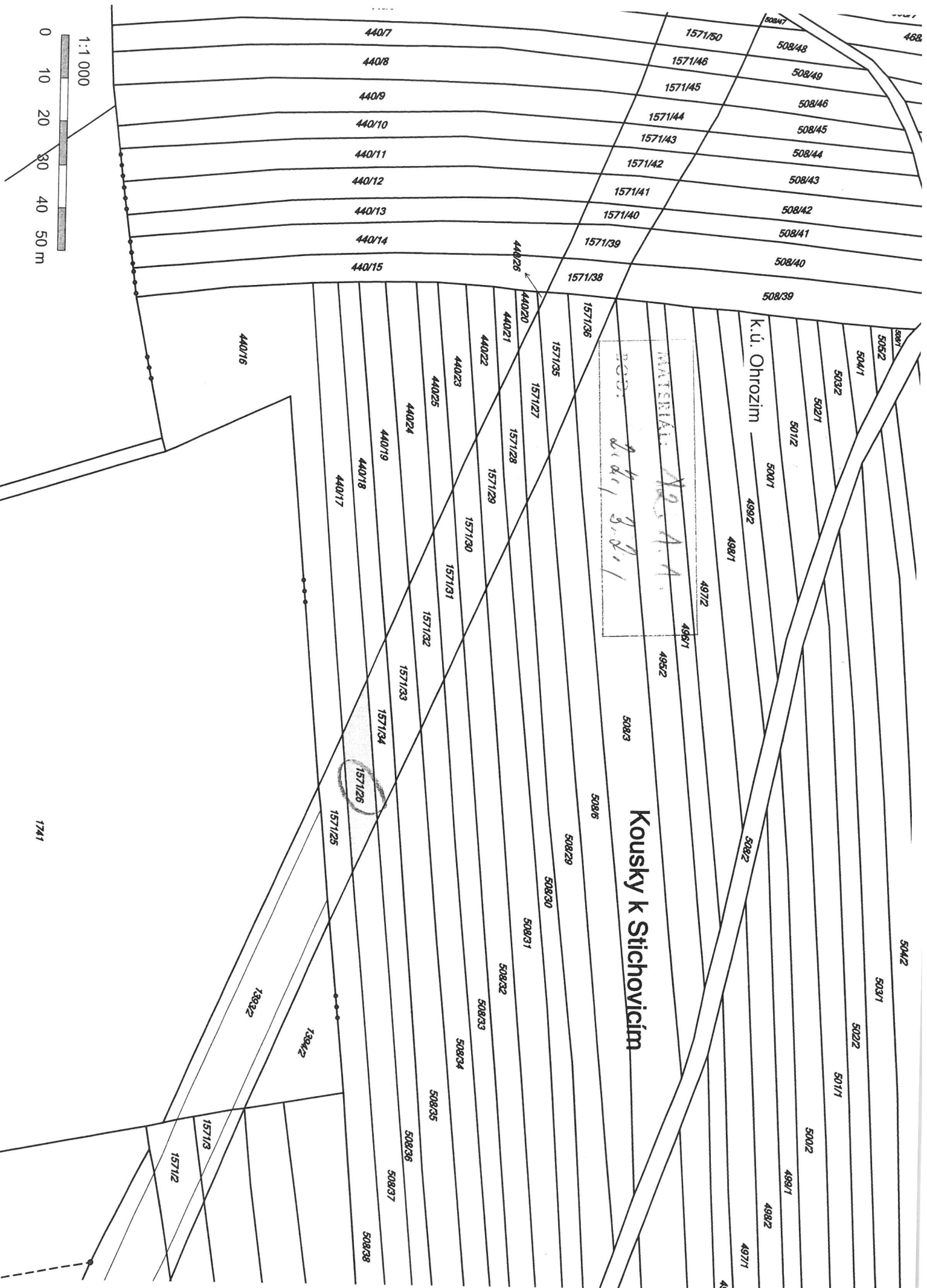

Kouský k Stichovicím

K.ú. Ohrozim

MATERIAL: 22.1.11
508/31

1571/26

km
psh



HOVA SITUACE KAZORU

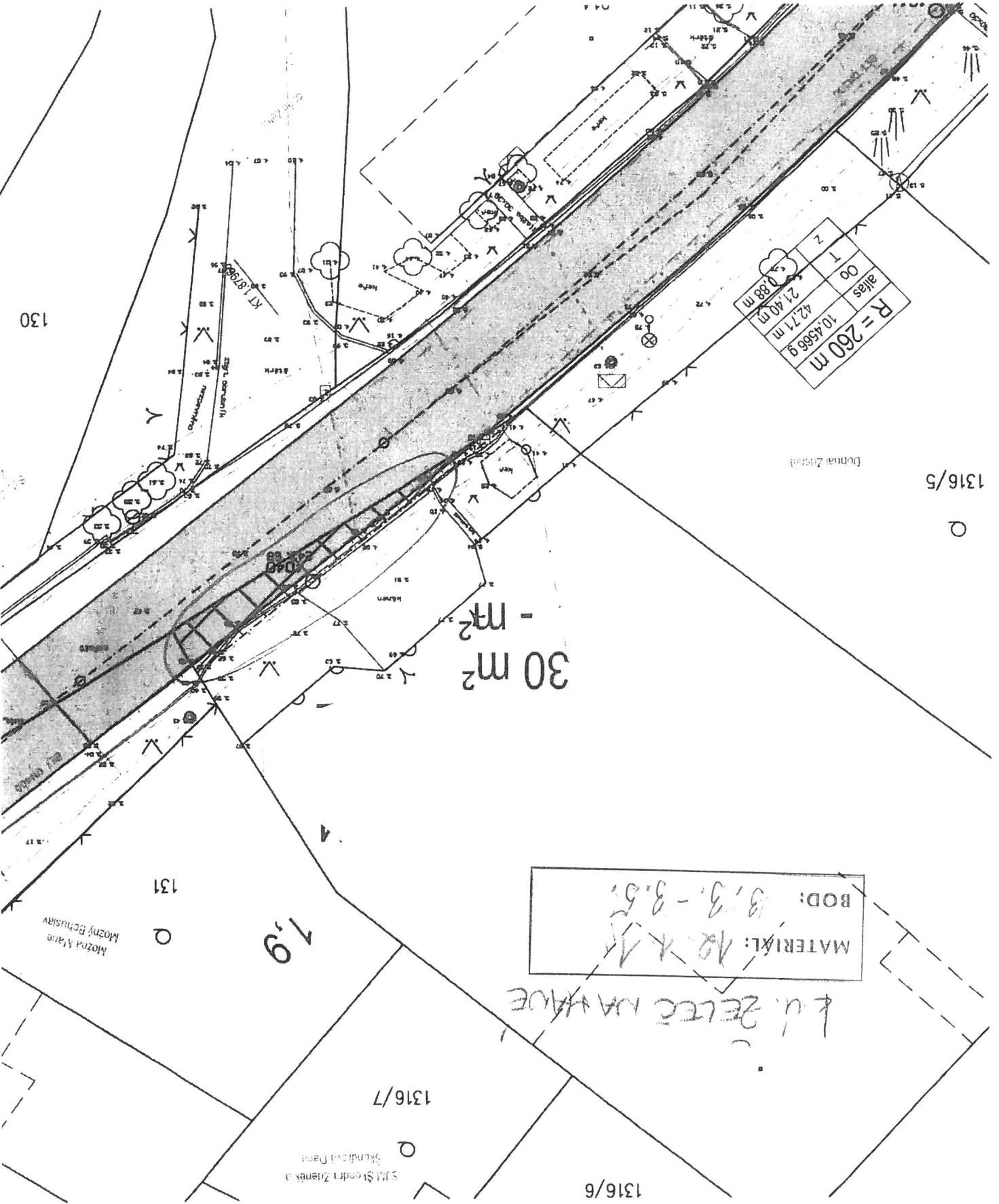

R = 260 m	altas	00	T	Z
10.4566 g	42.71 m	21.40 m	0.88 m	

MATERIÁL: 12.2.1
 BOD: 3.3 - 3.5

k. u. ZETEC NAVAHOE

30 m² - m²

1.0

130

1316/5

0

131

Mozná stava
 možný behuslav

1316/7

Stredová časť
 Stredová časť

1316/6

V3
add. (BUS)