

k.ú. Děřichov

Záhumerky

PROJEKT
1:1.000
11.11.1997

Děřichov

Děřichov

U Oskavy

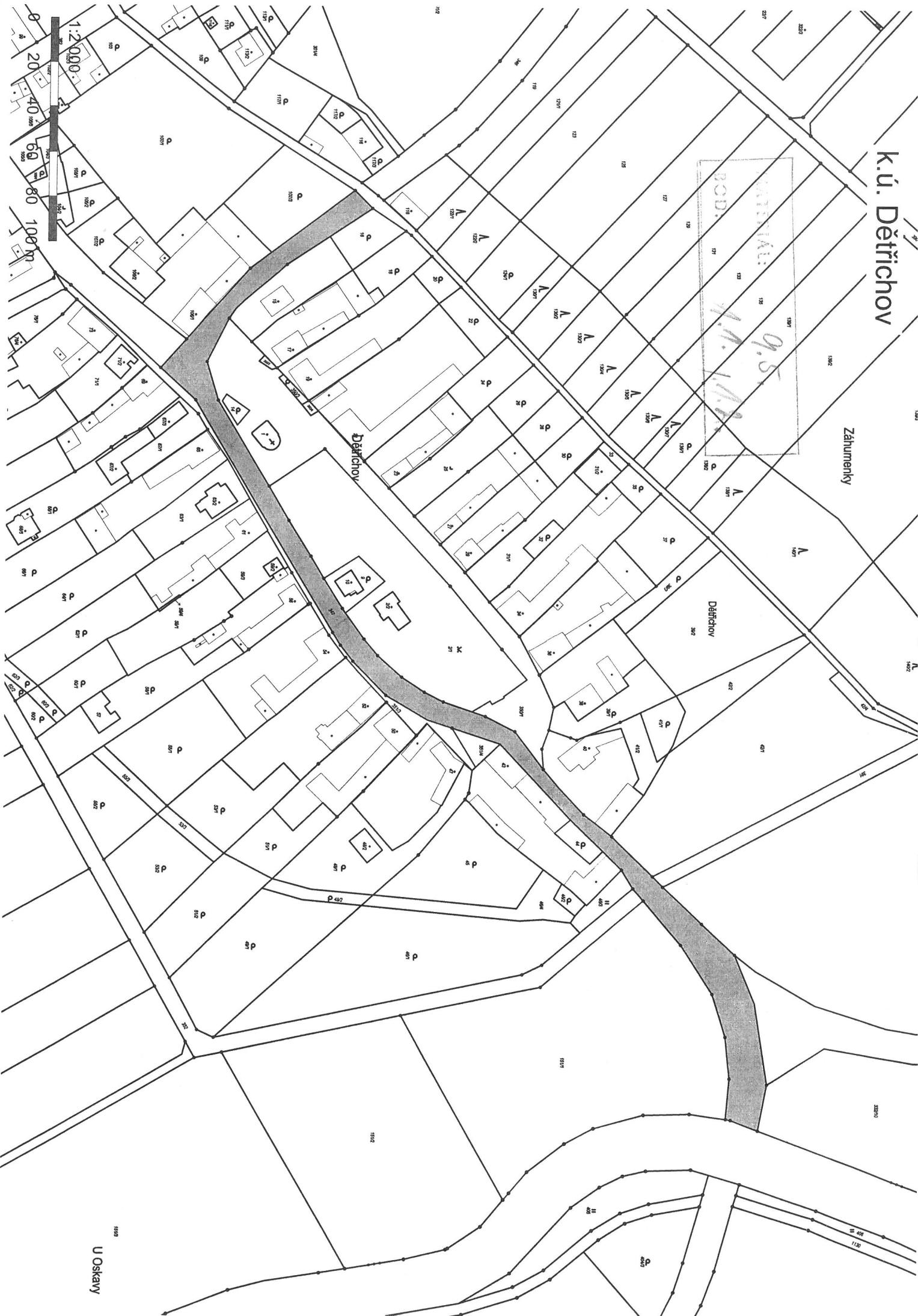

K.ú. Děřichov

Základní

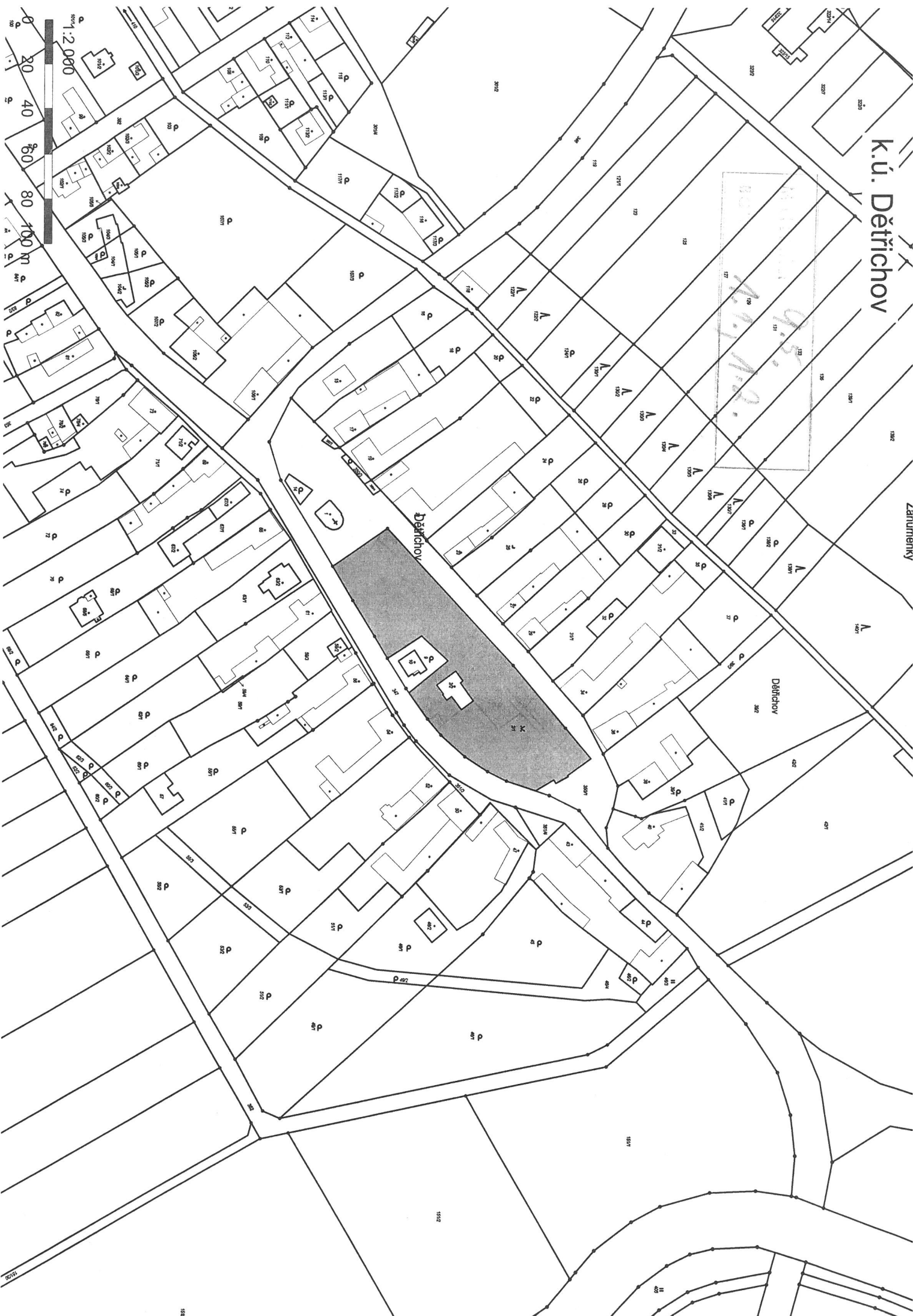

K.Ú. HONĚVOŘKA

MATERIÁL: 9.5.
BOD: 1.3., 1.4.

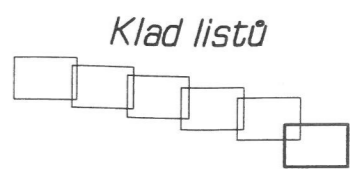

SEZNAM SOUŘADNIC (S-JTSK)

Č.bodu	Y	X	Kód kv.	Poznámka
456-673	552059.75	1123598.43	7	barva
456-678	552023.08	1123640.45	7	barva
459-726	552052.22	1123608.78	7	kolík
1131-257	552461.82	1123553.33	3	obrubiník
1	552447.48	1123554.87	3	obrubiník
2	552446.56	1123554.49	3	obrubiník
3	552445.10	1123554.16	3	obrubiník
4	552444.12	1123554.10	3	obrubiník
5	552419.40	1123556.59	3	obrubiník
6	552418.45	1123556.82	3	obrubiník
7	552417.59	1123557.34	3	obrubiník
8	552416.67	1123558.34	3	obrubiník
9	552406.96	1123559.54	3	obrubiník
10	552406.48	1123559.12	3	obrubiník
11	552405.60	1123558.62	3	obrubiník
12	552404.68	1123558.28	3	obrubiník
13	552403.68	1123558.15	3	obrubiník
14	552383.83	1123560.29	3	obrubiník
15	552341.48	1123564.67	3	obrubiník
16	552322.55	1123566.50	3	obrubiník
17	552298.65	1123568.69	3	obrubiník
18	552270.75	1123571.25	3	obrubiník
19	552232.27	1123574.86	3	obrubiník
20	552213.88	1123576.52	3	obrubiník
21	552212.82	1123576.93	3	obrubiník
22	552211.88	1123577.67	3	obrubiník
36	552185.12	1123580.15	3	obrubiník
37	552181.20	1123579.61	3	obrubiník
38	552159.43	1123581.65	3	obrubiník
39	552117.71	1123585.46	3	obrubiník
40	552103.81	1123586.81	3	obrubiník
41	552100.46	1123587.14	3	obrubiník
42	552095.52	1123587.79	3	obrubiník
43	552086.61	1123589.22	3	obrubiník
44	552083.56	1123589.91	7	obrubiník
45	552079.76	1123590.76	3	obrubiník
50	552073.06	1123592.77	3	obrubiník
51	552068.35	1123594.60	3	obrubiník
54	552064.76	1123596.37	3	obrubiník
58	552059.60	1123599.42	3	obrubiník
59	552058.32	1123600.40	7	obrubiník
60	552055.63	1123602.47	3	obrubiník
61	552047.41	1123609.81	3	obrubiník
62	552043.39	1123614.28	3	obrubiník
63	552035.06	1123624.25	3	obrubiník
64	552032.04	1123628.28	3	obrubiník
65	552031.55	1123629.11	3	obrubiník
66	552030.91	1123630.85	7	obrubiník

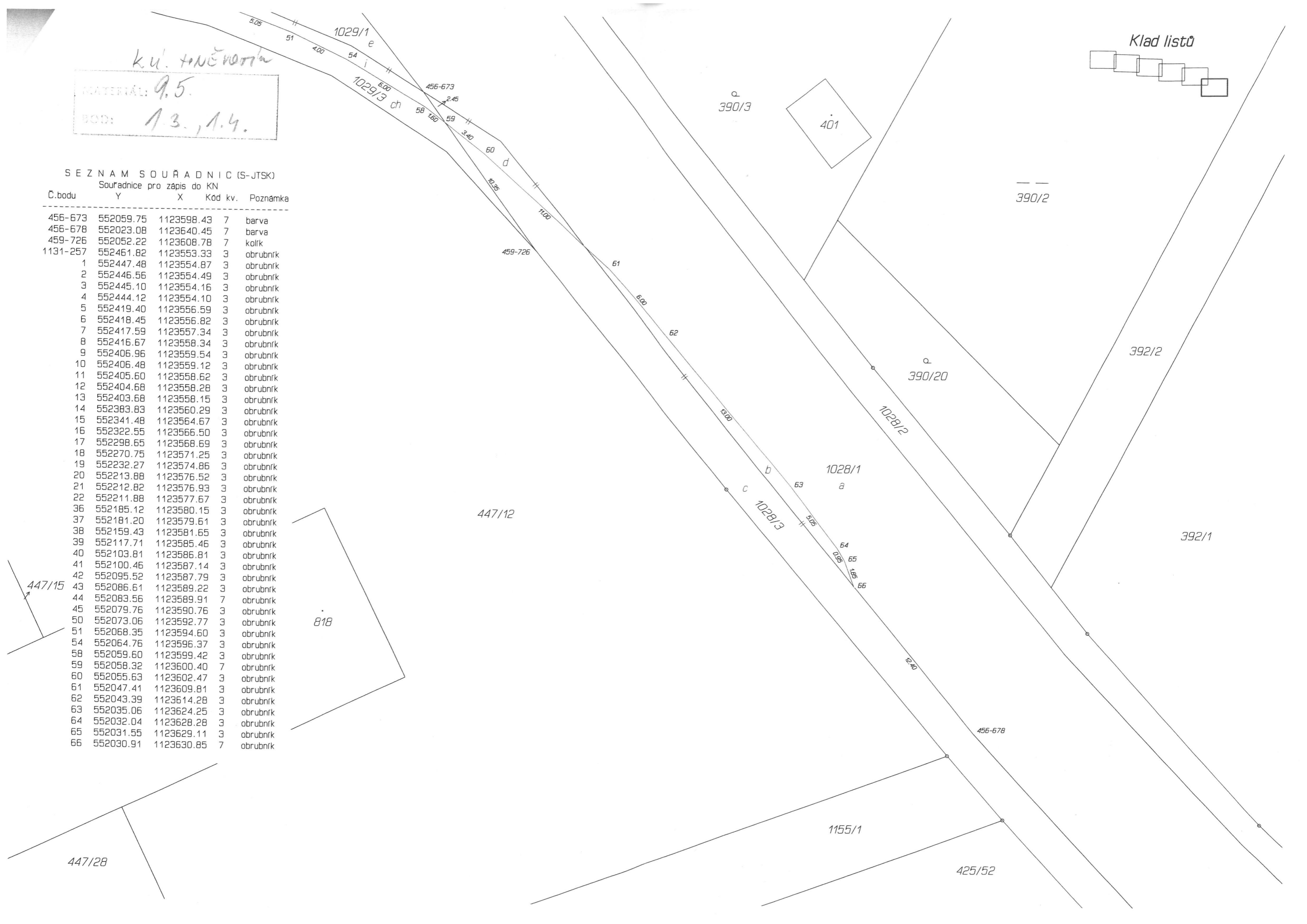

u ul. HNĚVOTY 12

MATERIÁL: 9.5.
BOD: 1.3., 1.4.

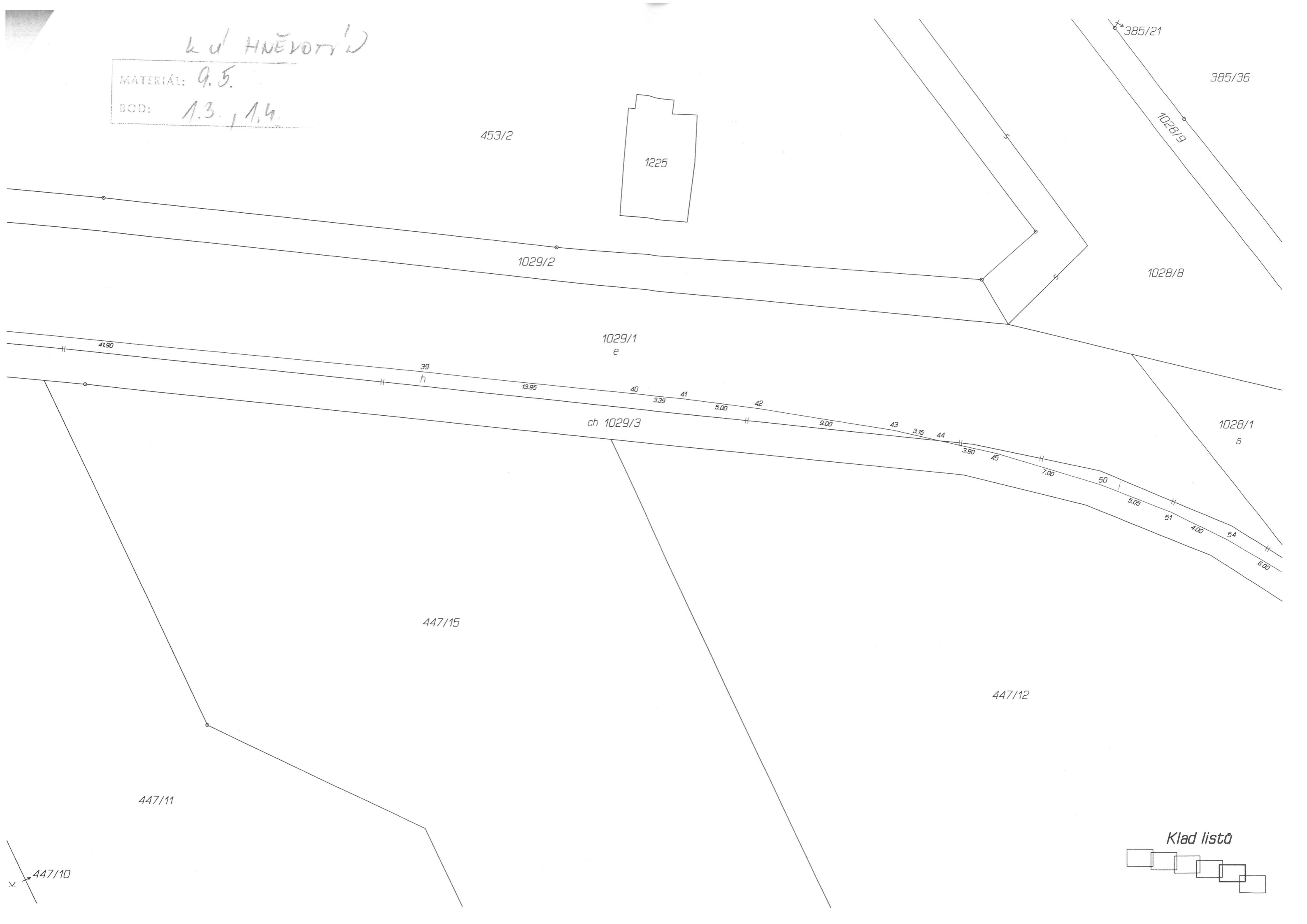

Klad listů

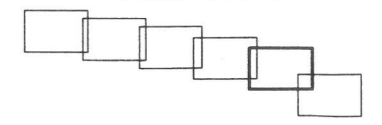

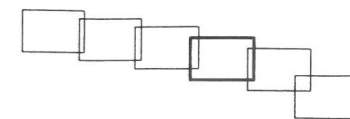

k.u. HNĚVOTÍN

MATERIÁL: 9.5.
BOD: 1.3, 1.4.

455

453/1

453/2

1029/2

1029/1
e

1029/3 ch

18.45
g
1.15
20 21 22

26.85

36 3.95 37

21.89

38

h

447/27

447/10

447/11

447/9

762

810

809

447/22

447/23

k.d. HNEVOTI'~

MATERIÁL: 1.5.
BOD: 1.3., 1.4.



||
132/1

+
131

||
455

456/3

132/14

1029/2

17

1029/1
e

28.00

18

g

38.65

1029/3
ch

19

447/27

447/1

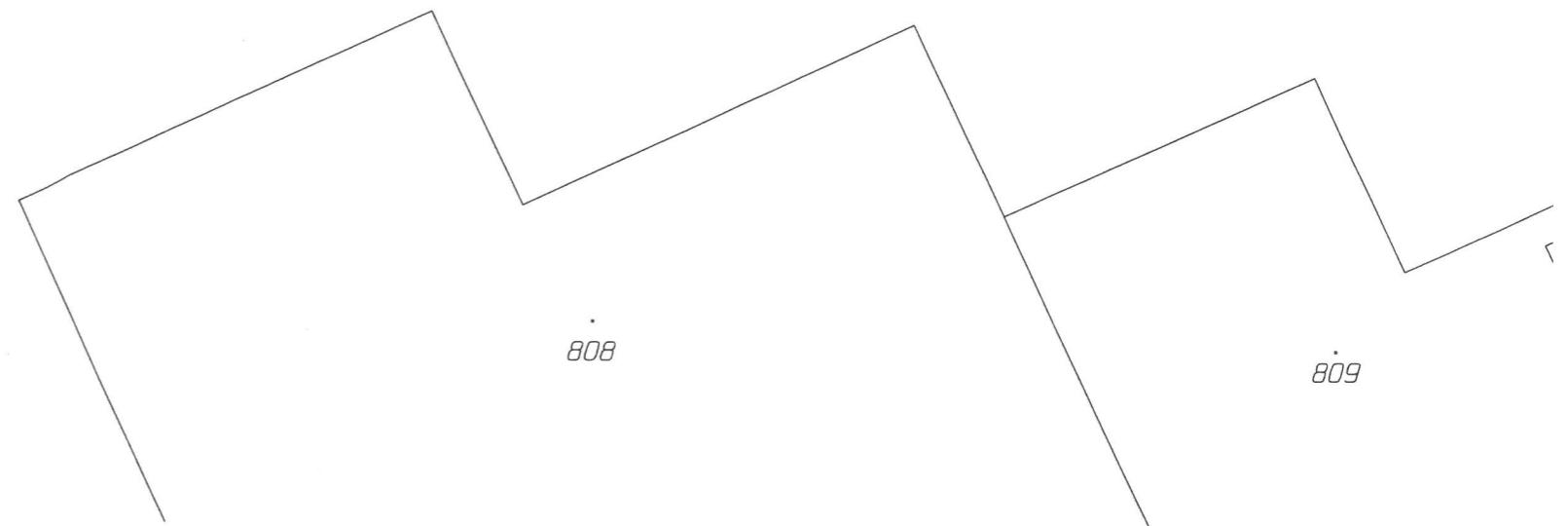

Klad listô

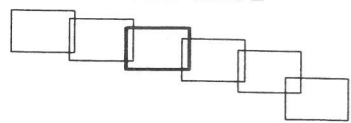

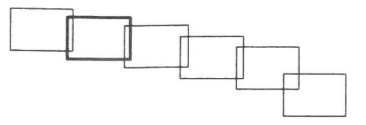

k. u. l. HNĚVOTIČ

MATERIÁL: 9.5.
BOD: 1.3., 1.4.

132/1

456/3

1029/2

1029/1
e

14

42.60

g

15

1029/3
ch

19.00

15

1029/4

24.00

444/3

447/2

447/1

772

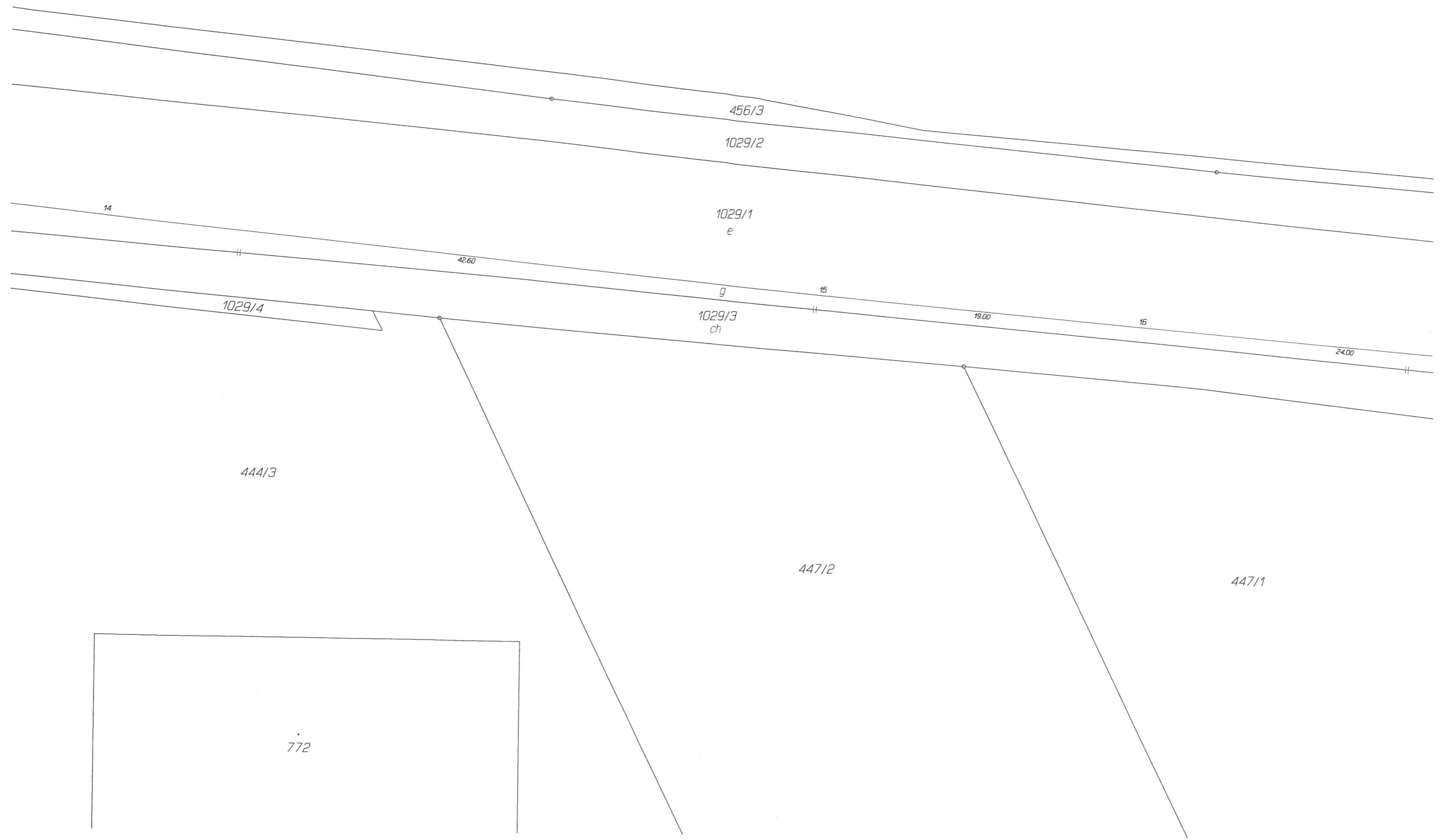
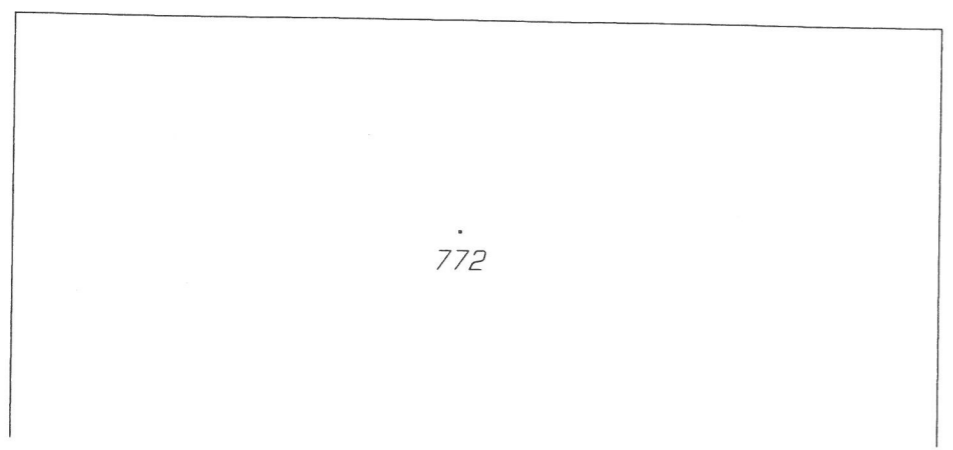

k.u. HNĚNOTÍN

Klad listů

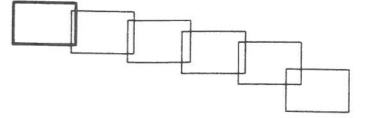

MATERIÁL: 9.5.
BOD: 1.3, 1.4.

456/7

456/3

456/6

132/1

449

206

1029/2

1029/1
e

1029/16

1029/7

1029/8

1029/9

1029/3
ch

1029/10

1029/4

444/64

444/33

444/29

444/32

444/36

444/3

343/6

344

366/3

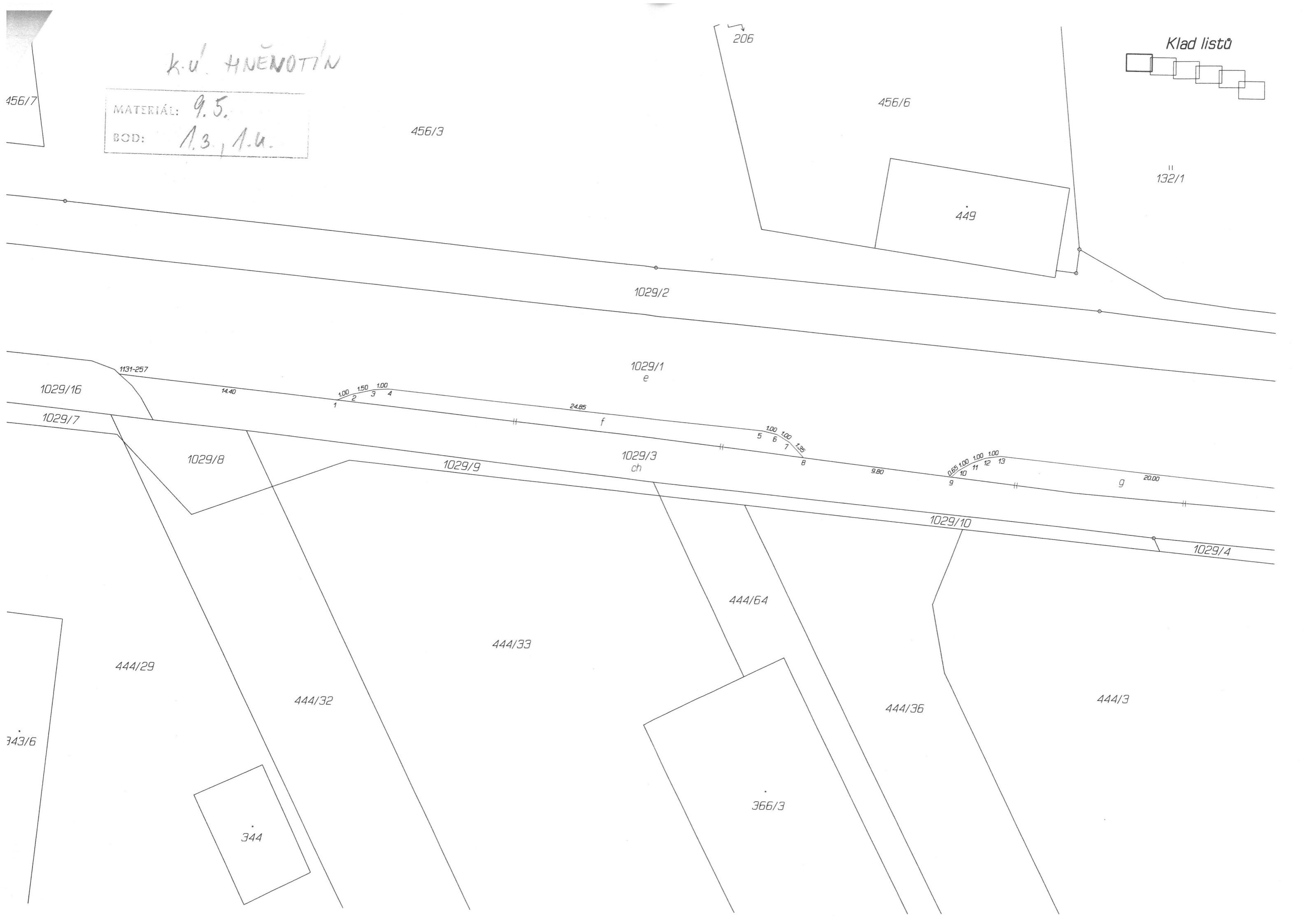

K.ú. Hrabíšín



k.ú. Hradišín

MATERIÁL: 9.5.
BOD.: 15.16

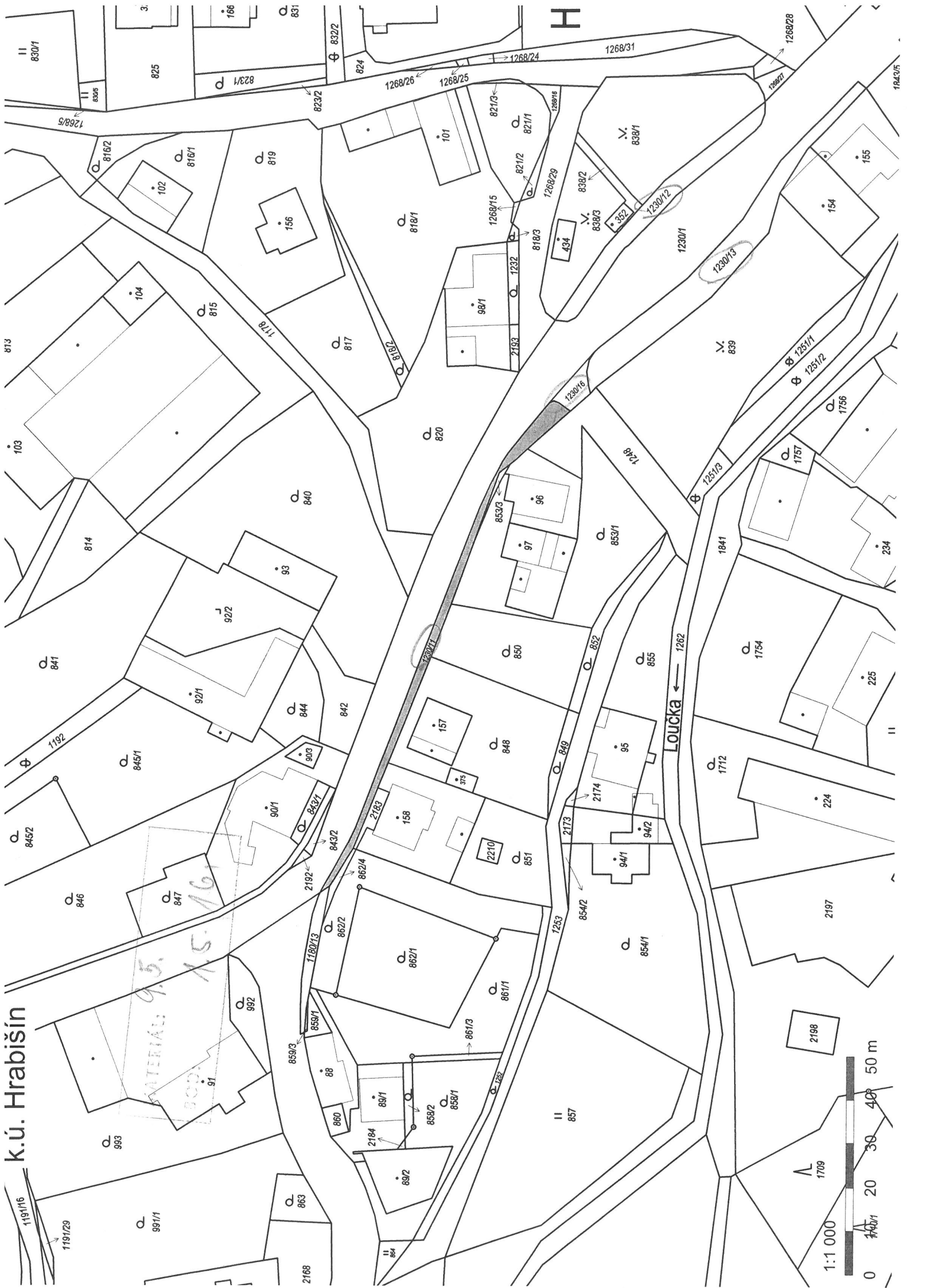

k.ú. Hradišín

MATEŘKA: 9.5.
BOC: 1.5.1.6.

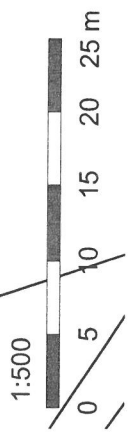
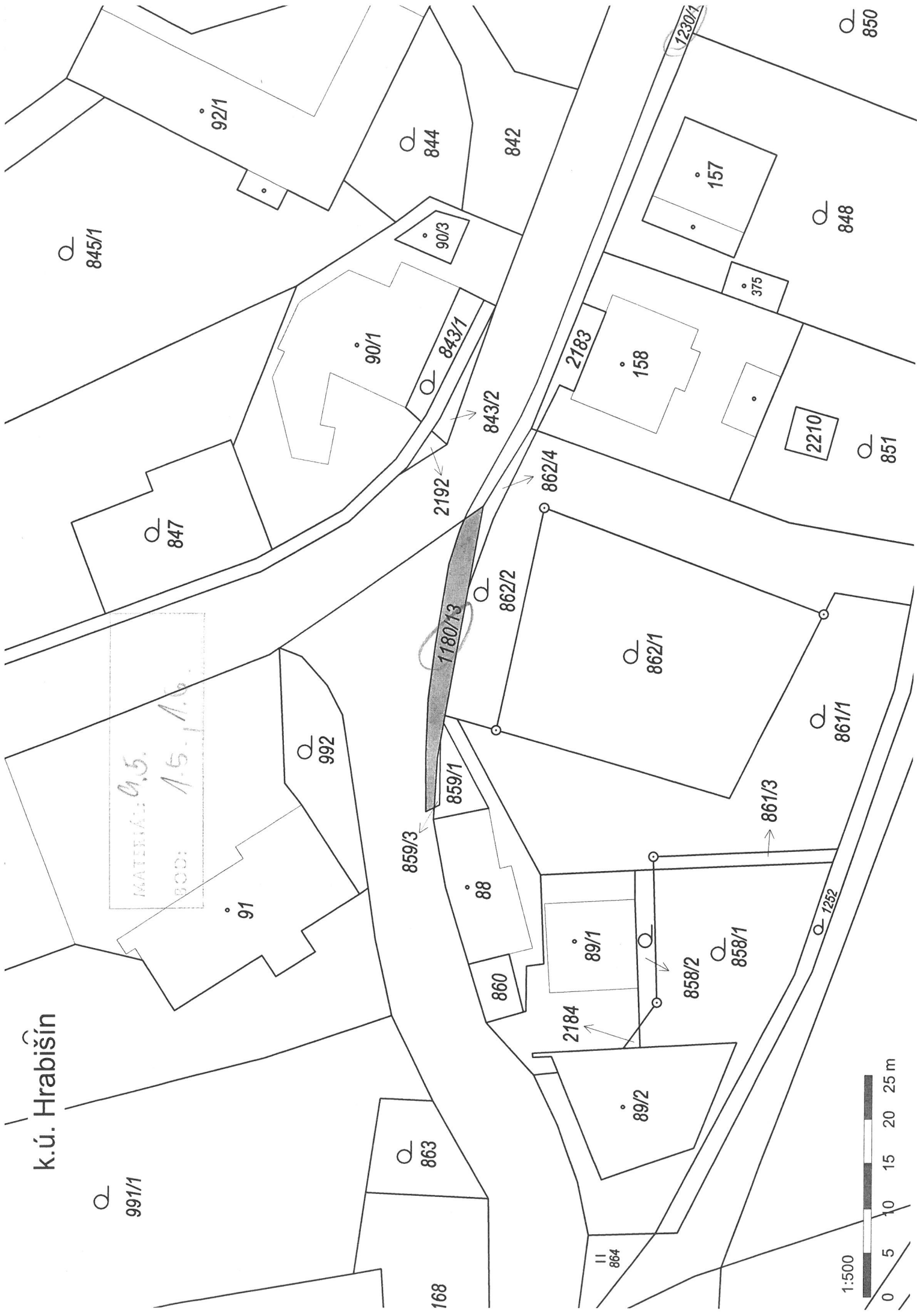

k.ú. Hrabišín

SCALE: 1:1000
DATE: 15.1.16

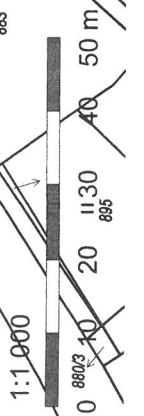

k.ú. Hrabíšín

WATERÁK: 9.5.
BOD: A.5. A.6



1:1 000

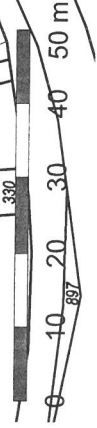



k.ú. Hradišín

MATEŘKA: 9.5.
DÚ: 1.5. A. 5.0.

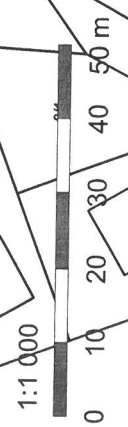

Scale: 9.5.
Date: 1.5.16.

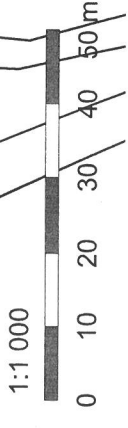
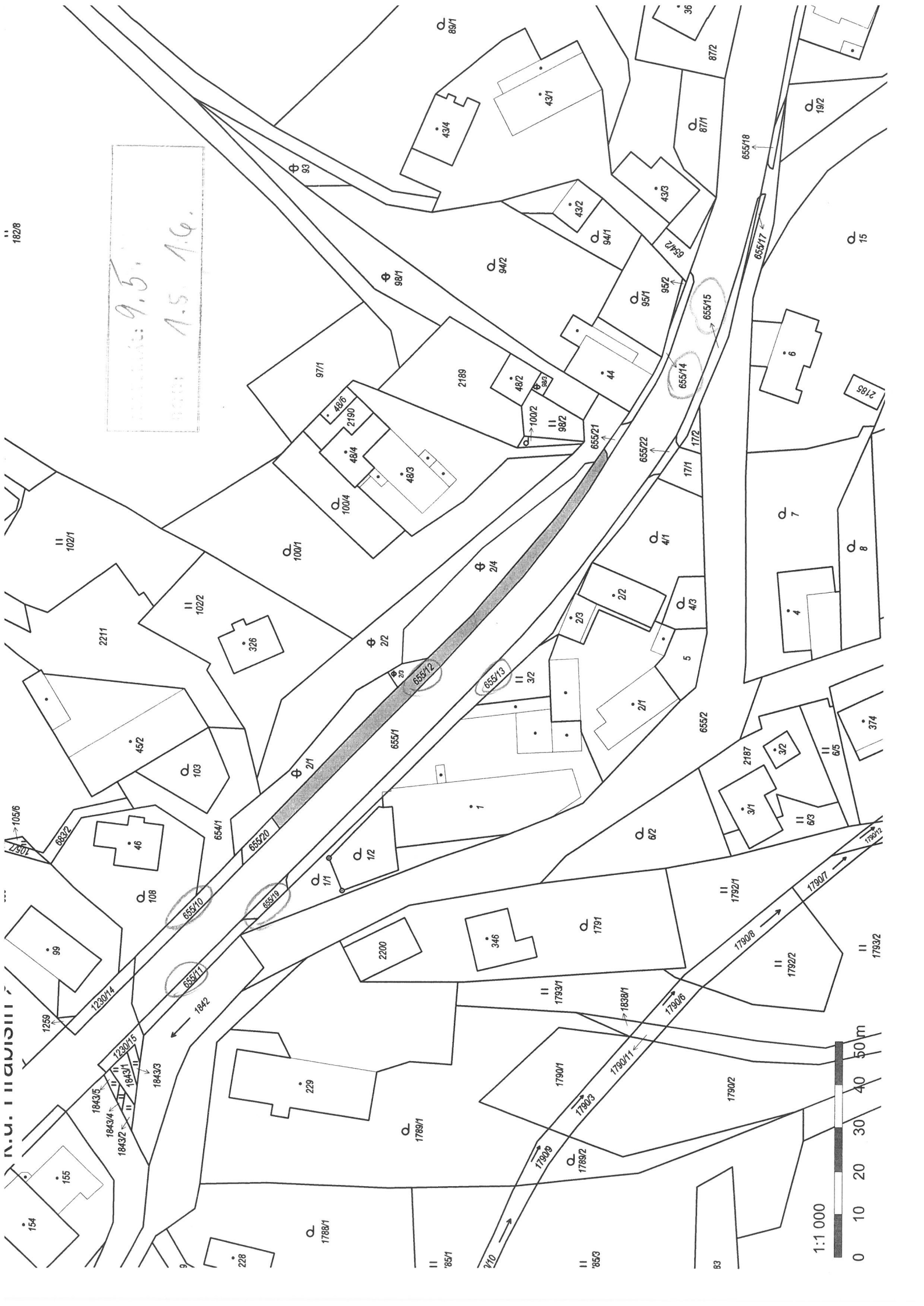

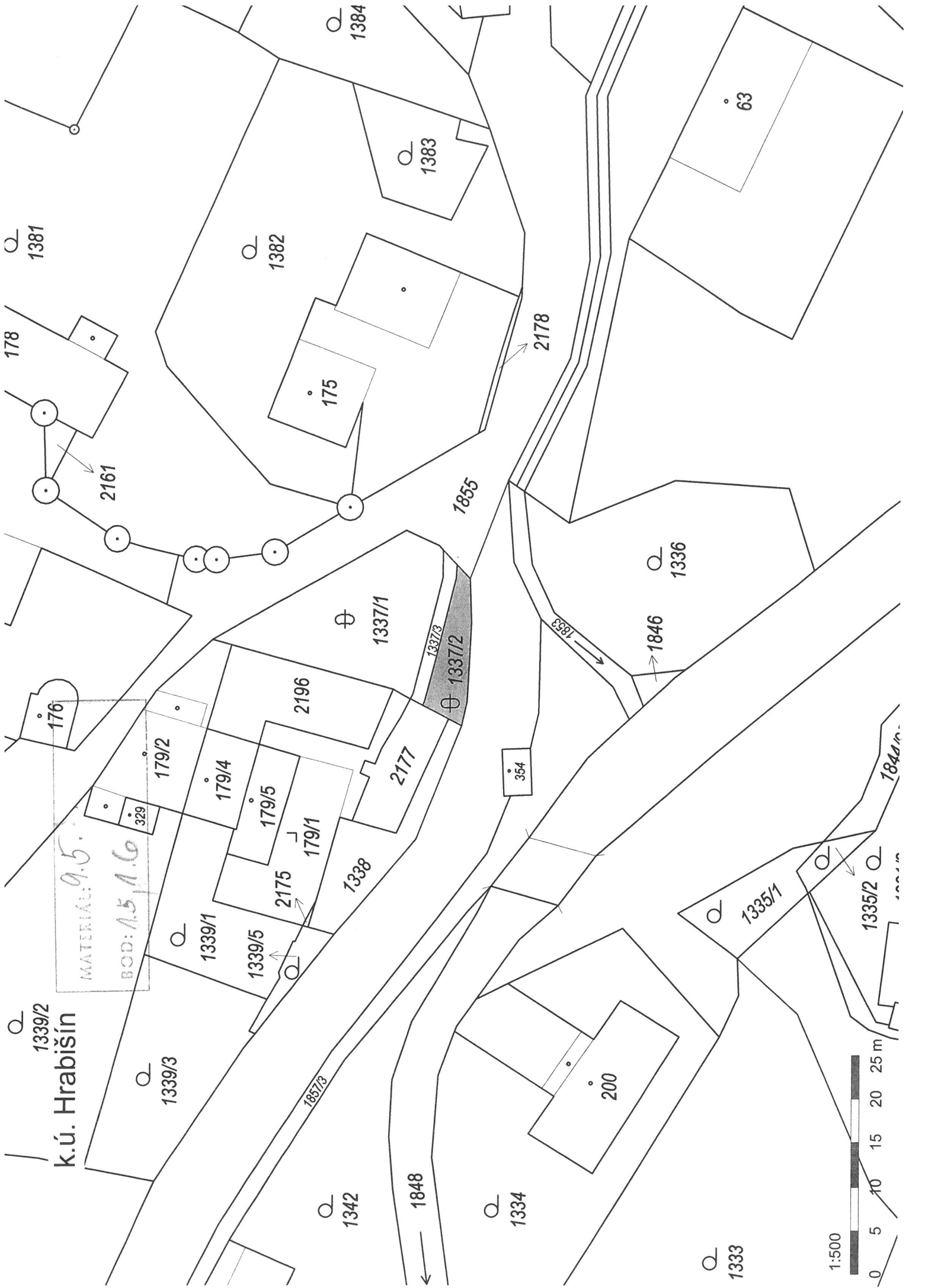

MATERIÁL: 9.5.
 BOD: 1.5, 1.6

1337/2

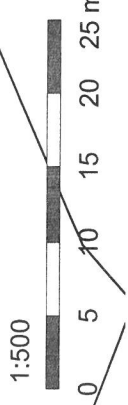

935/3

935/11

1180/9

72

890

71

891

893

935/16

935/10

402

462

892

MATERIÁL: 9.5.
BOD: A.5.1 A.6.

k.ú. Hrabíšín

412

400

935/9

935/41

894/3

894/1

894/2

423

397

935/8

1180/10

350

933/4

933/5

69

935/52

1:500



N.U. IINDUISIII

1388

173/2

1389

1393/2

1264/20

MATERIA: 2182
9.5,
1.5.1.1.6.

915

2179/4

2179/3

916/4

916/3

1264/19

64

917

922

153

921

923/1

920

935/42

935/40

923/2

92

913

1:500





2038
2401
1302

124
1308
1306/1
1305/7
1305/8
1305/9
1305/6
1305/10
1305/1
1305/2
1305/3
1305/4

126
1244
1254
1261/8
1258
1260/1
1261/9
1261/10
1261/12
1261/14
1263/8
1263/2
1263/9

298
1265/4
1265/1
1266/2
1256/4
1266/1
1265/2
1265/3
1265/1
1272/5
1272/3
1272/4

118
1267/2
1267/1
1267/5
1273/1
1274
1272/1
1272/2
1272/5
1276/1
1270/2
1279/1

122
1271
1256/5
1256/6
1282
1280/2
1284/20
1284/1
1284/3
1280/3
1286/7
1286/3
1279/2
1286/2
1286/4
1286/5

380
1285
1288/5
1288/2
1288/4
1288/7
1287
1279/2
1286/2
1286/4
1286/5

708
1304/1
1300/2
1300/4
1300/3
1300/1

116
1290
1294/1
1299
1291
1292/4
1292/3
1292/5
1293
1294/2
1296

115
1298
1299
1291
1292/4
1292/3
1292/5
1293
1294/2
1296

E 18
1288
1289

Area 9.5

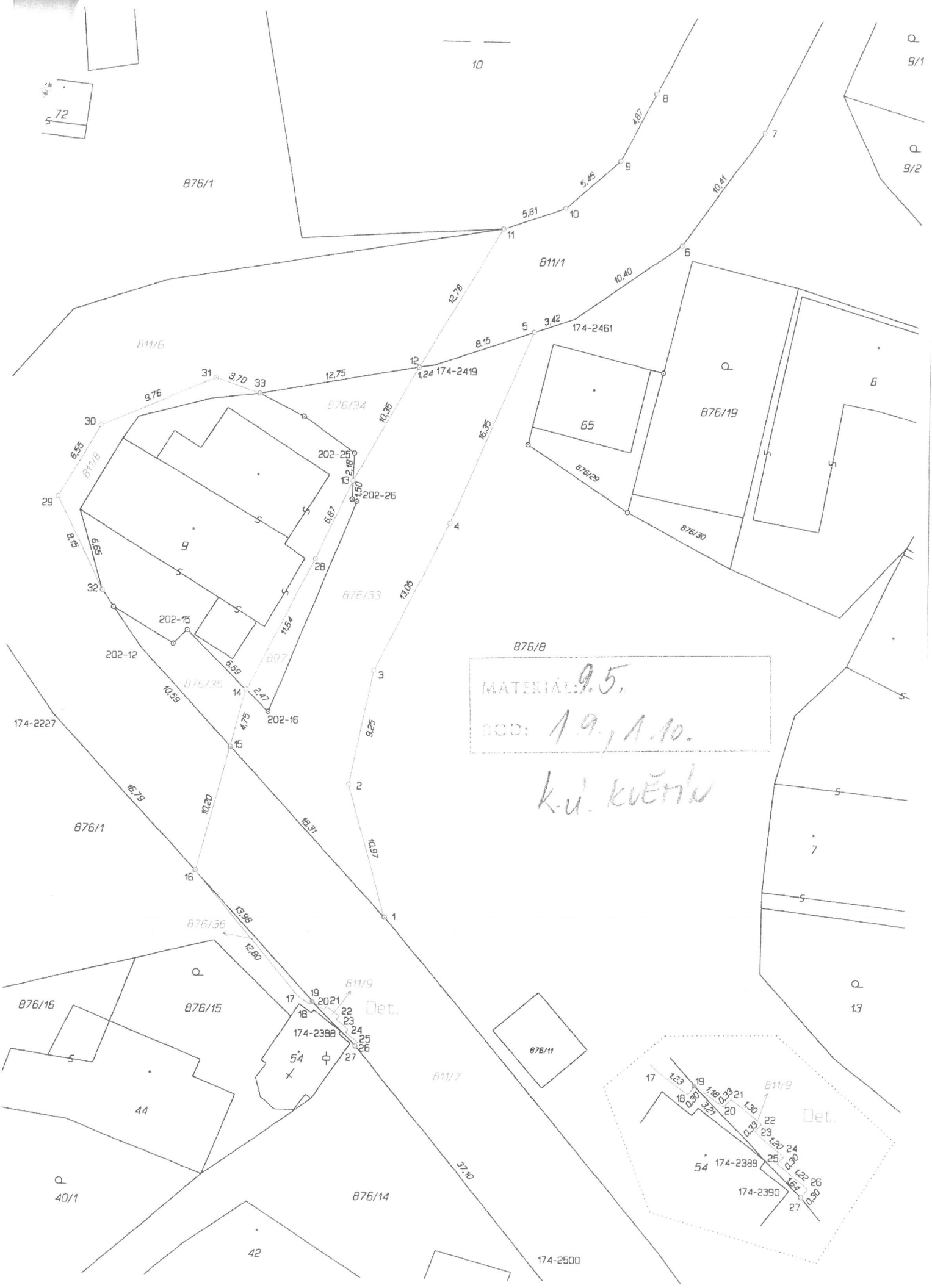

MATERIAL: 9.5.
 BOD: 1.9, 1.10.

k.u. květnu

10

Q
9/1
Q
9/2

72
75

876/1

811/1

811/6

876/34

876/19

876/33

876/8

Q
13

7

876/15

811/9 Det.

876/15

876/11

811/9 Det.

44

811/7

Q
40/1

876/14

174-2500

42