

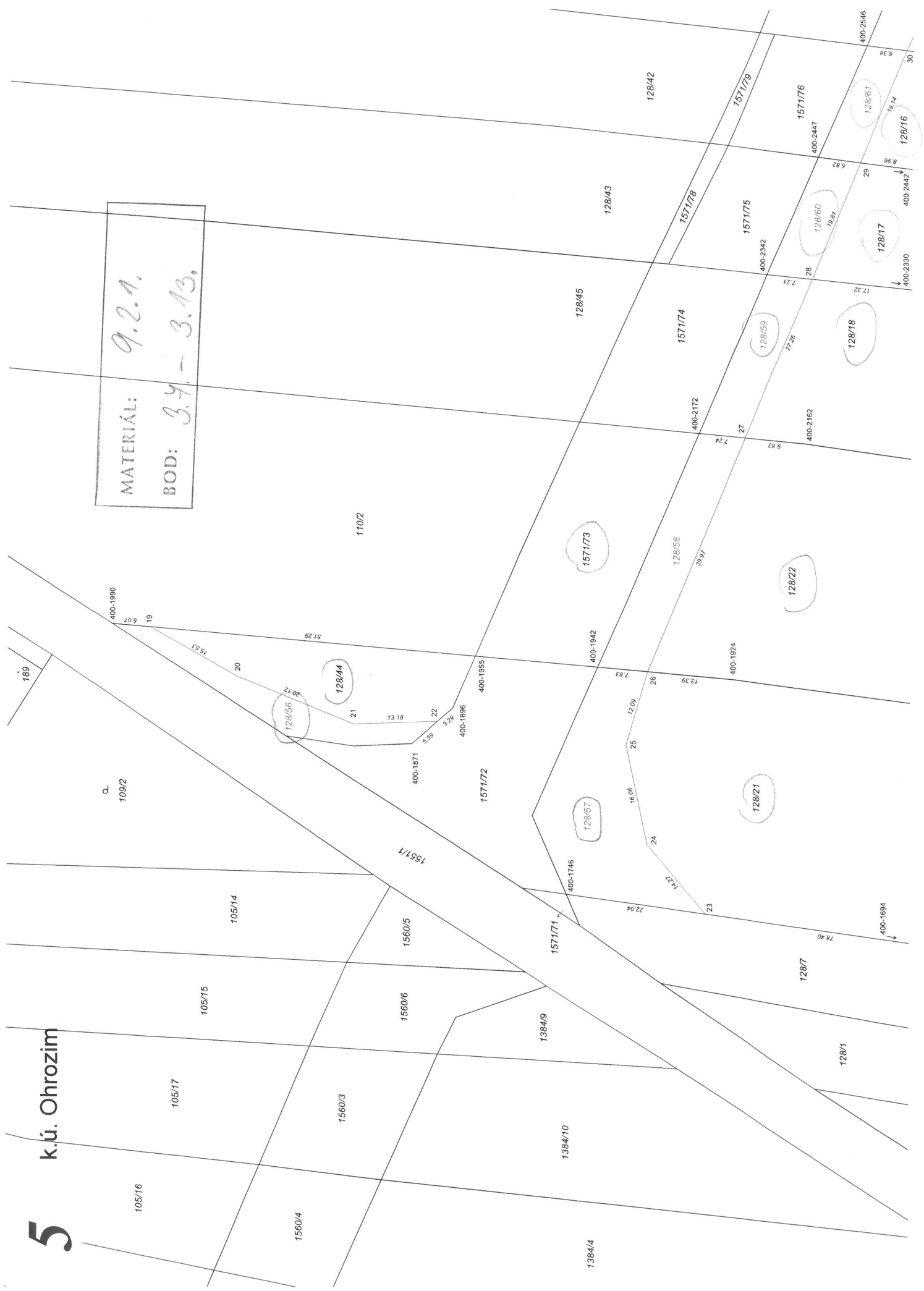

5

k.ú. Ohrozim

MATERIÁL: 9.2.1.  
BOD: 3.4. - 3.13.





8

MATERIAL: 9.2.1.  
1.9. - A.M.  
BOD: 3.16. - B.R.

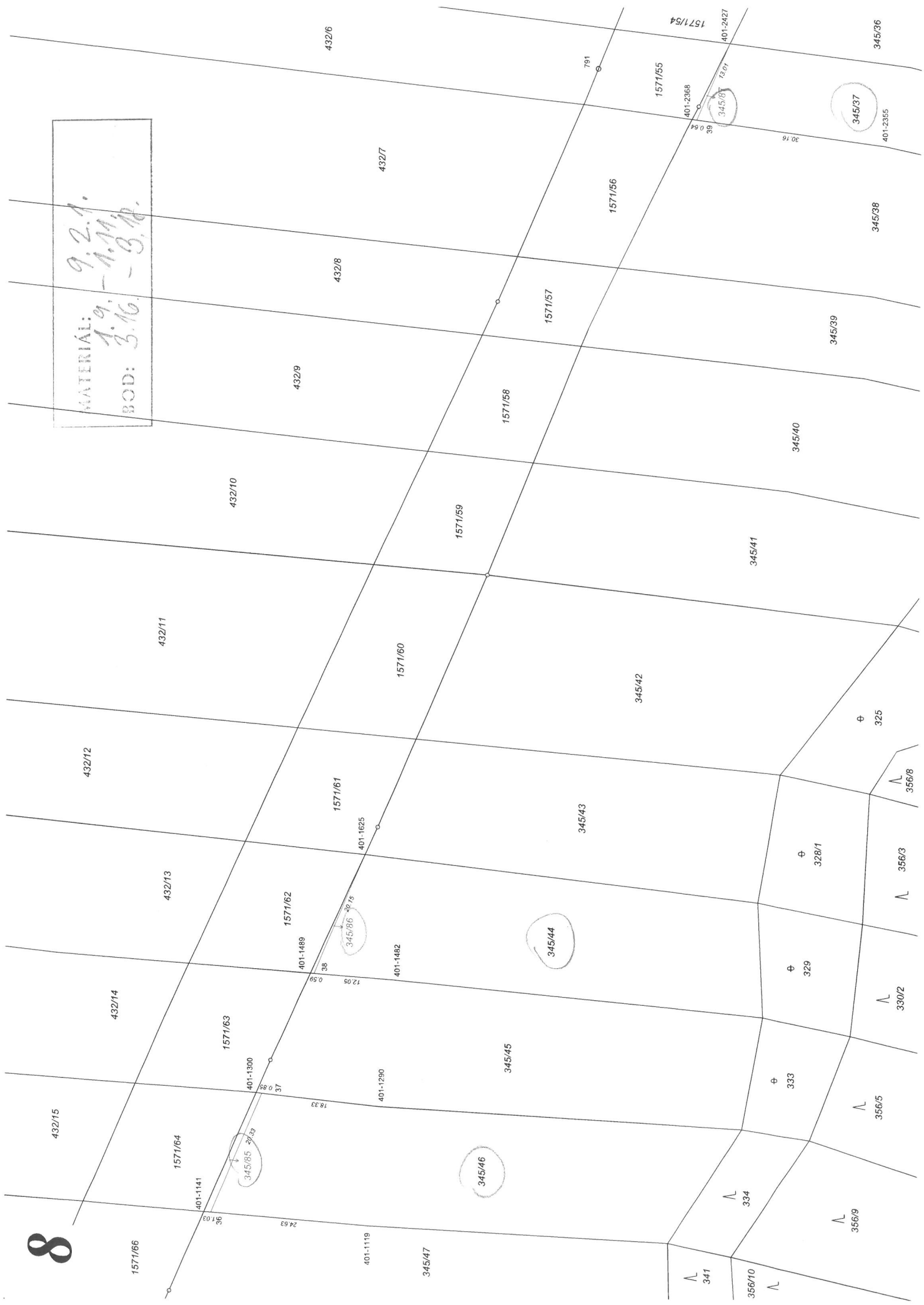

1571/66

1571/64

1571/63

1571/62

1571/61

1571/60

1571/59

1571/58

1571/57

1571/56

1571/55

1571/54

432/15

432/14

432/13

432/12

432/11

432/10

432/9

432/8

432/7

432/6

401-1141

401-1300

401-1488

401-1625

401-1482

401-1290

401-2368

401-2427

401-2355

401-2355

401-2355

401-2355

345/65

345/85

345/86

345/87

345/88

345/89

345/90

345/91

345/92

345/47

345/46

345/45

345/44

345/43

345/42

345/41

345/40

345/39

345/66

345/67

345/68

345/69

345/70

345/71

345/72

345/73

345/74

345/75

345/76

345/77

345/78

345/79

345/80

345/81

345/82

345/83

345/84

345/85

345/86

345/87

345/88

345/89

345/90

345/91

345/92

345/93

345/94

345/95

345/96

345/97

345/98

345/99

345/100

345/101

345/102

345/103

345/104

345/105

345/106

345/107

345/108

345/109

345/110

345/111

345/112

345/113

345/114

345/115

345/116

345/117

345/118

345/119

345/120

345/121

345/122

345/123

345/124

345/125

345/126

345/127

345/128

345/129

345/130

345/131

345/132

345/133

345/134

345/135

345/136

345/137

345/138

345/139

345/140

345/141

345/142

345/143

345/144

345/145

345/146

345/147

345/148

345/149

345/150

345/151

345/152

345/153

345/154

345/155

345/156

345/157

345/158

345/159

345/160

345/161

345/162

345/163

345/164

345/165

345/166

345/167

345/168

345/169

345/170

345/171

345/172

345/173

345/174

345/175

345/176

345/177

345/178

345/179

345/180

345/181

345/182

345/183

345/184

345/185

345/186

345/187

345/188

345/189

345/190

345/191

345/192

345/193

345/194

345/195

345/196

345/197

345/198

345/199

345/200

345/201

345/202

345/203

345/204

345/205

345/206

345/207

345/208

345/209

345/210

345/211

345/212

345/213

345/214

345/215

345/216

345/217

345/218

345/219

345/220

345/221

345/222

345/223

345/224

345/225

345/226

345/227

345/228

345/229

345/230

345/231

345/232

345/233

345/234

345/235

345/236

345/237

345/238

345/239

345/240

345/241

345/242

345/243

345/244

345/245

345/246

345/247

345/248

345/249

345/250

345/251

345/252

345/253

345/254

345/255

345/256

345/257

345/258

345/259

345/260

345/261

345/262

345/263

345/264

345/265

345/266

345/267

345/268

345/269

345/270

345/271

345/272

345/273

345/274

345/275

345/276

345/277

345/278

345/279

345/280

345/281

345/282

345/283

345/284

345/285

345/286

345/287

345/288

345/289

345/290

345/291

345/292

345/293

345/294

345/295

345/296

345/297

345/298

345/299

345/300

345/301

345/302

345/303

345/304

MATERIÁL: 9. 1. 1. 508/2  
3. 1. 1. - 1. 1. 1. 502/1  
3. 1. 1. - 3. 1. 1. 501/2

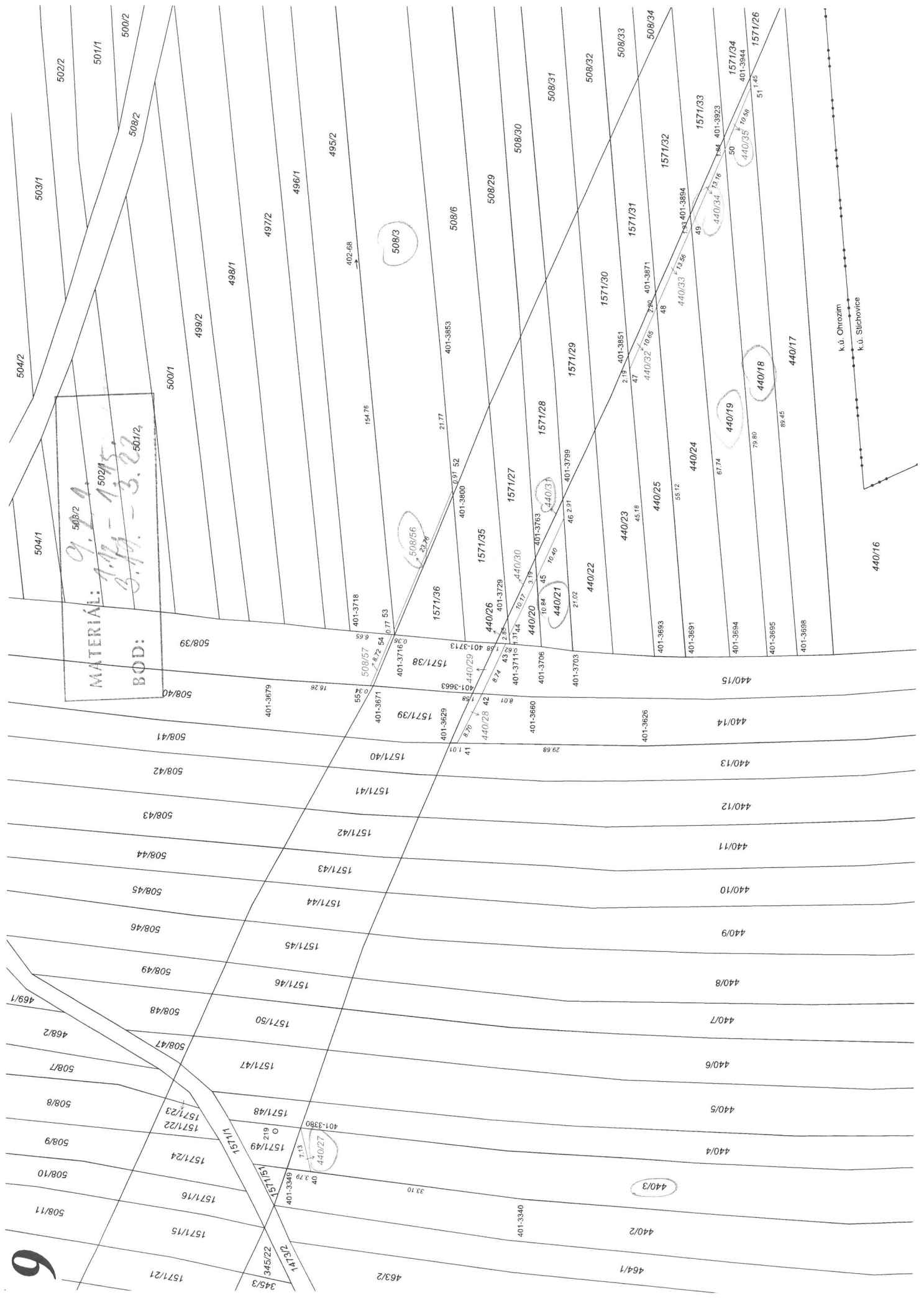

k.ú. Ohrozin  
k.ú. Slichovice

440/16

440/17

440/18

440/19

440/20

440/21

440/22

440/23

440/24

440/25

440/26

440/27

440/28

440/29

440/30

440/31

440/32

440/33

440/34

440/35

440/36

440/37

440/38

440/39

440/40

440/41

440/42

440/43

440/44

440/45

440/46

440/47

440/48

440/49

440/50

440/51

440/52

440/53

440/54

440/55

440/56

440/57

440/58

440/59

440/60

440/61

440/62

440/63

440/64

440/65

440/66

440/67

440/68

440/69

440/70

440/71

440/72

440/73

440/74

440/75

440/76

440/77

440/78

440/79

440/80

440/81

440/82

440/83

440/84

440/85

440/86

440/87

440/88

440/89

440/90

440/91

440/92

440/93

440/94

440/95

440/96

440/97

440/98

440/99

440/100

440/101

440/102

440/103

440/104

440/105

440/106

440/107

440/108

440/109

440/110

440/111

440/112

440/113

440/114

440/115

440/116

440/117

440/118

440/119

440/120

440/121

440/122

440/123

440/124

440/125

440/126

440/127

440/128

440/129

440/130

440/131

440/132

440/133

440/134

440/135

440/136

440/137

440/138

440/139

440/140

440/141

440/142

440/143

440/144

440/145

440/146

440/147

440/148

440/149

440/150

440/151

440/152

440/153

440/154

440/155

440/156

440/157

440/158

440/159

440/160

440/161

440/162

440/163

440/164

440/165

440/166

440/167

440/168

440/169

440/170

440/171

440/172

440/173

440/174

440/175

440/176

440/177

440/178

440/179

440/180

440/181

440/182

440/183

440/184

440/185

440/186

440/187

440/188

440/189

440/190

440/191

440/192

440/193

440/194

440/195

440/196

440/197

440/198

440/199

440/200

440/201

440/202

440/203

440/204

440/205

440/206

440/207

440/208

440/209

440/210

440/211

440/212

440/213

440/214

440/215

440/216

440/217

440/218

440/219

440/220

440/221

440/222

440/223

440/224

440/225

440/226

440/227

440/228

440/229

440/230

440/231

440/232

440/233

440/234

440/235

440/236

440/237

440/238

440/239

440/240

440/241

440/242

440/243

440/244

440/245

440/246

440/247

440/248

440/249

440/250

440/251

440/252

440/253

440/254

440/255

440/256

440/257

440/258

440/259

440/260

440/261

440/262

440/263

440/264

440/265

440/266

440/267

440/268

440/269

440/270

440/271

440/272

440/273

440/274

440/275

440/276

440/277

440/278

440/279

440/280

440/281

440/282

440/283

440/284

440/285

440/286

440/287

440/288

440/289

440/290

440/291

440/292

440/293

440/294

440/295

440/296

440/297

440/298

440/299

440/300

440/301

440/302

440/303

440/304

440/305

440/306

440/307

440/308

440/309

440/310

440/311



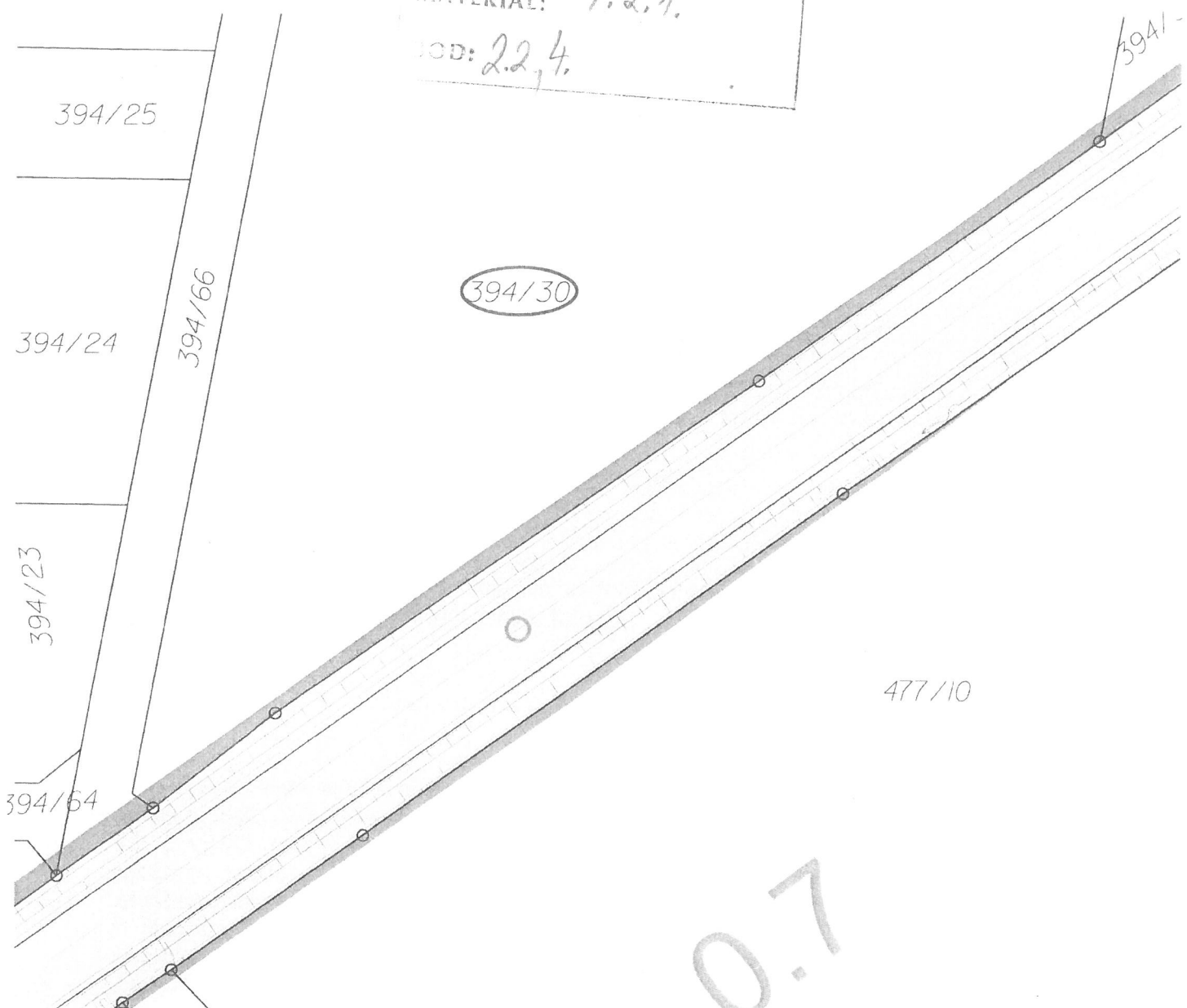

440/312

440

MATERIÁL: 9.2.1.  
KOD: 2.2.4.



LEGENDA:

- |                                                                                     |                           |                                                                                      |                                                                                       |
|-------------------------------------------------------------------------------------|---------------------------|--------------------------------------------------------------------------------------|---------------------------------------------------------------------------------------|
|  | TRVALÝ ZÁBOR - VÝKUP      |                                                                                      |  |
|  | TRVALÝ ZÁBOR - BEZ VÝKUPU |  | VĚCNÉ BŘEMENO                                                                         |
|  | DOČASNÝ ZÁBOR DO 1 ROKU   |  | KATASTRÁLNÍ HRANICE                                                                   |

MATERIÁL: 9.2.1  
BOD: 4.2.

k.u. HRADEČANY u PROSTĚJOV

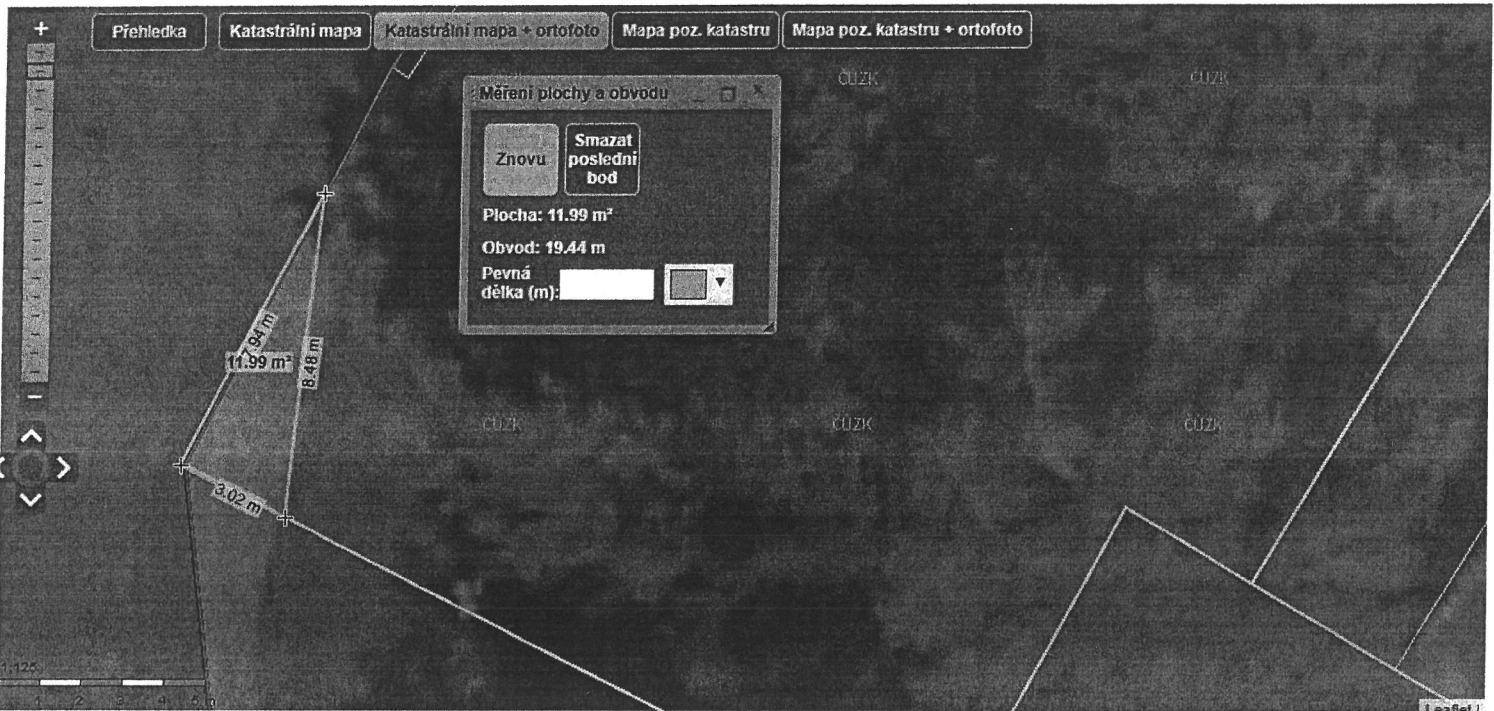

k.ú. Rouské

Průběh: 9.2.1.  
B.Ú. 4.3.



284/2

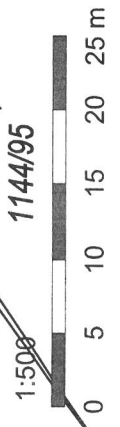



k.ú. Rouské

MATERIAL: 9.2.1.  
BOD: 4.3.

1144/69

1144/68

70

1144/67

1144/66

1144/65

1144/64

1144/63

1144/6

1144/7

1144/8

1144/9

1144/10

1:500

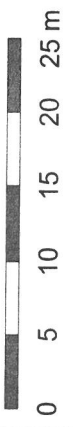

k.ú. Bystřička I

MATERIAL:

BOD:

9.2.1.

4.4.

26/1

7/1

45/1

867

45/10

101

863/5

45/11

863/11

U Mokrošů

479

478

480

45/12

1:500



216

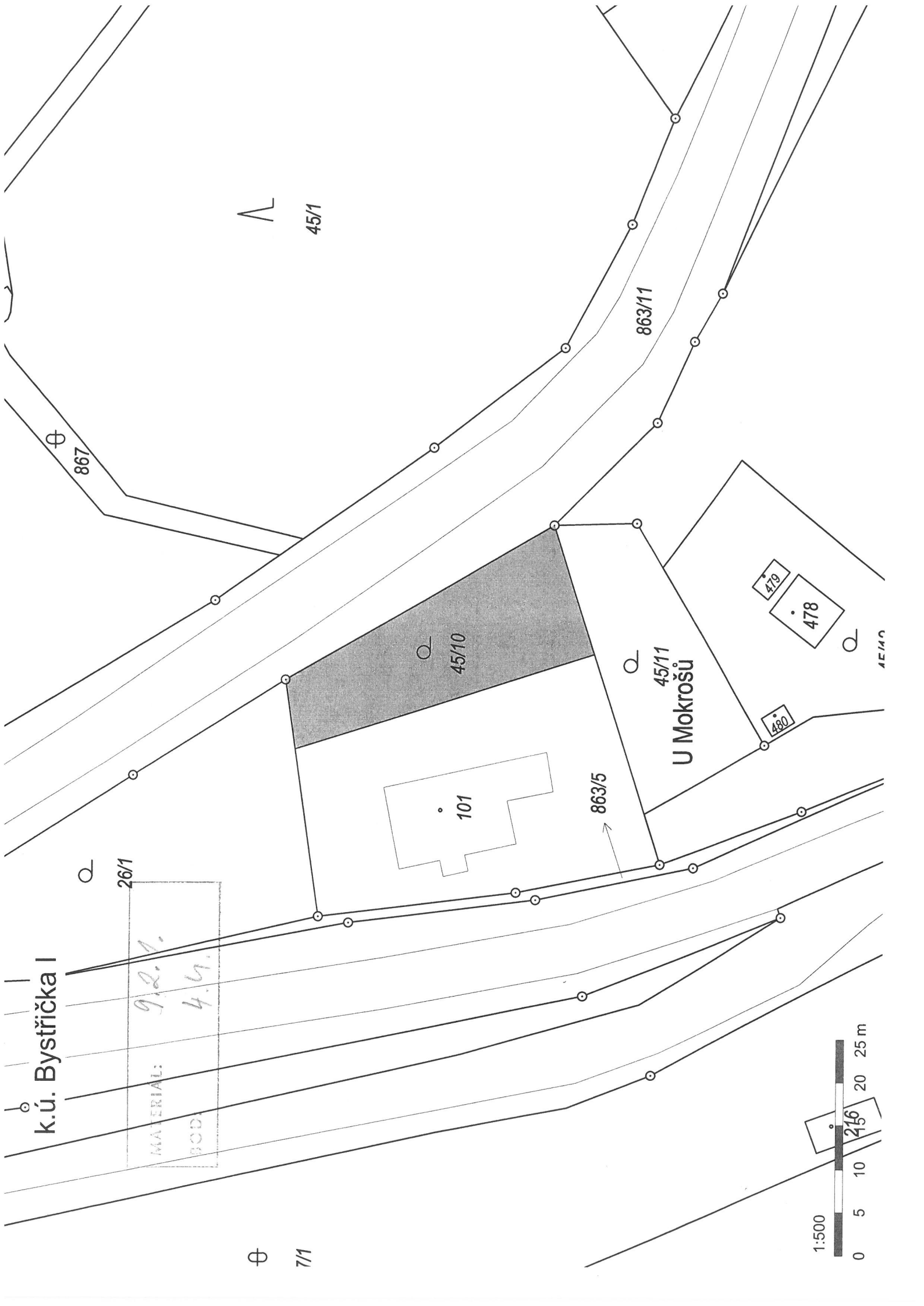

k.ú. Ruda nad Moravou

MATERIÁL: 9.2.1.  
BOD: 4.5.

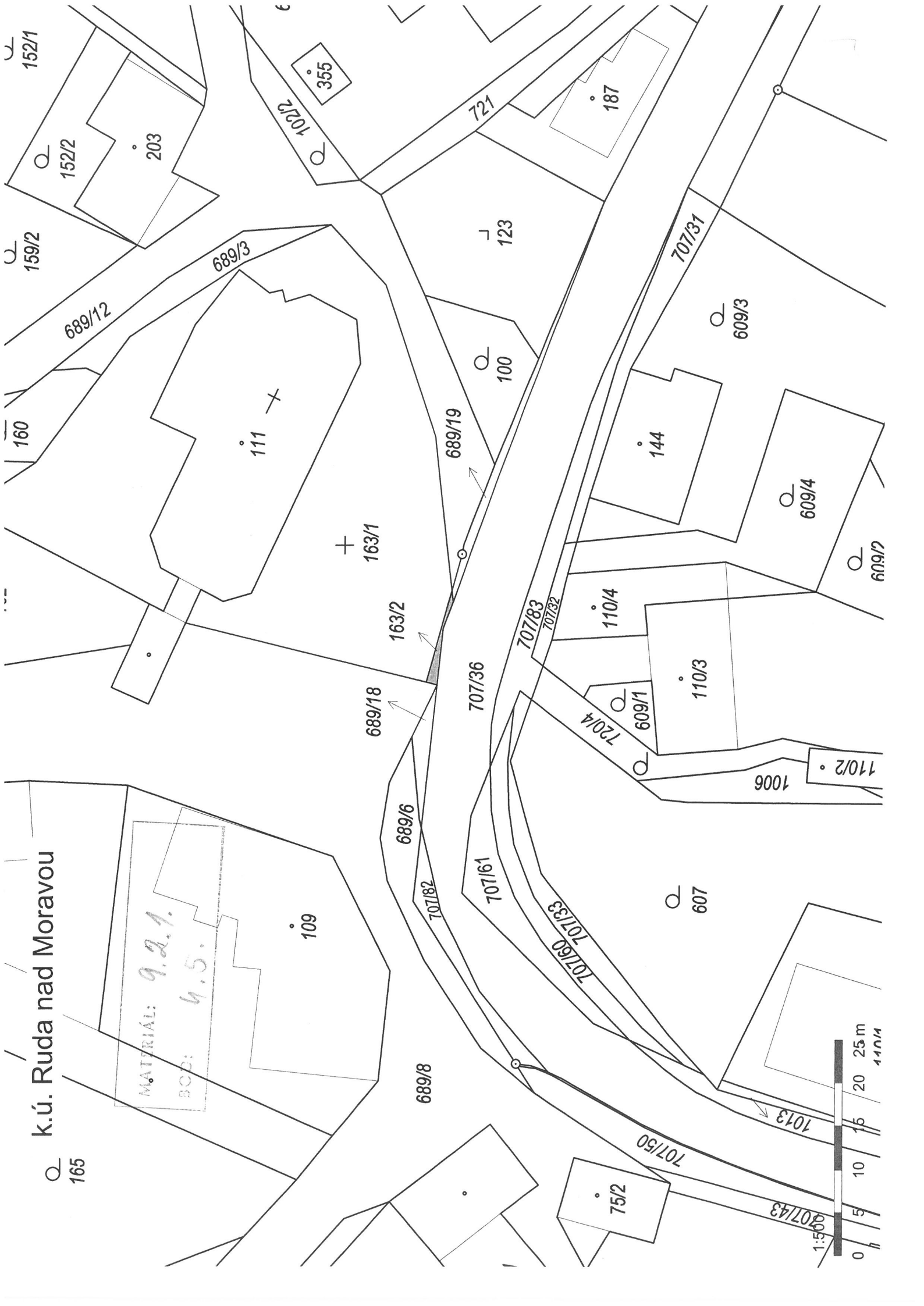

# Katastrální mapa - LV č. 1117, k.ú. Rapotín

14.04.23 10:26

Nahližení do katastru nemovitostí (standard) Tisk - 0s :62ms, 119 prvků.

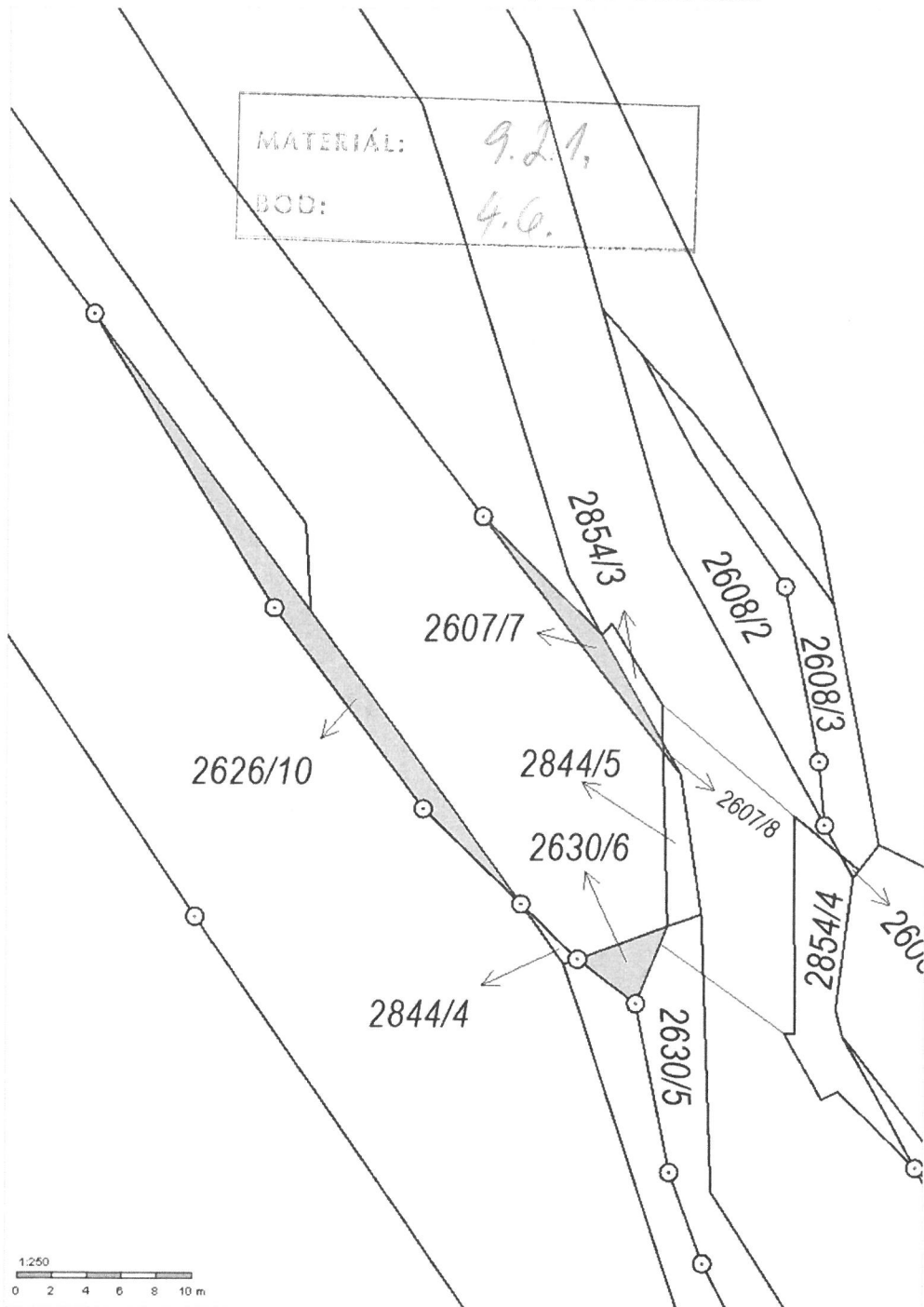

<https://sgi-nahlizenidokn.cuzk.cz/marushka/print.aspx>

1/1

Pozemky p.č. 2607/7, 2626/10 a 2630/6