

k.ú. Miroveček

MATERIÁL: 10.4.1.
POD: 1.1.

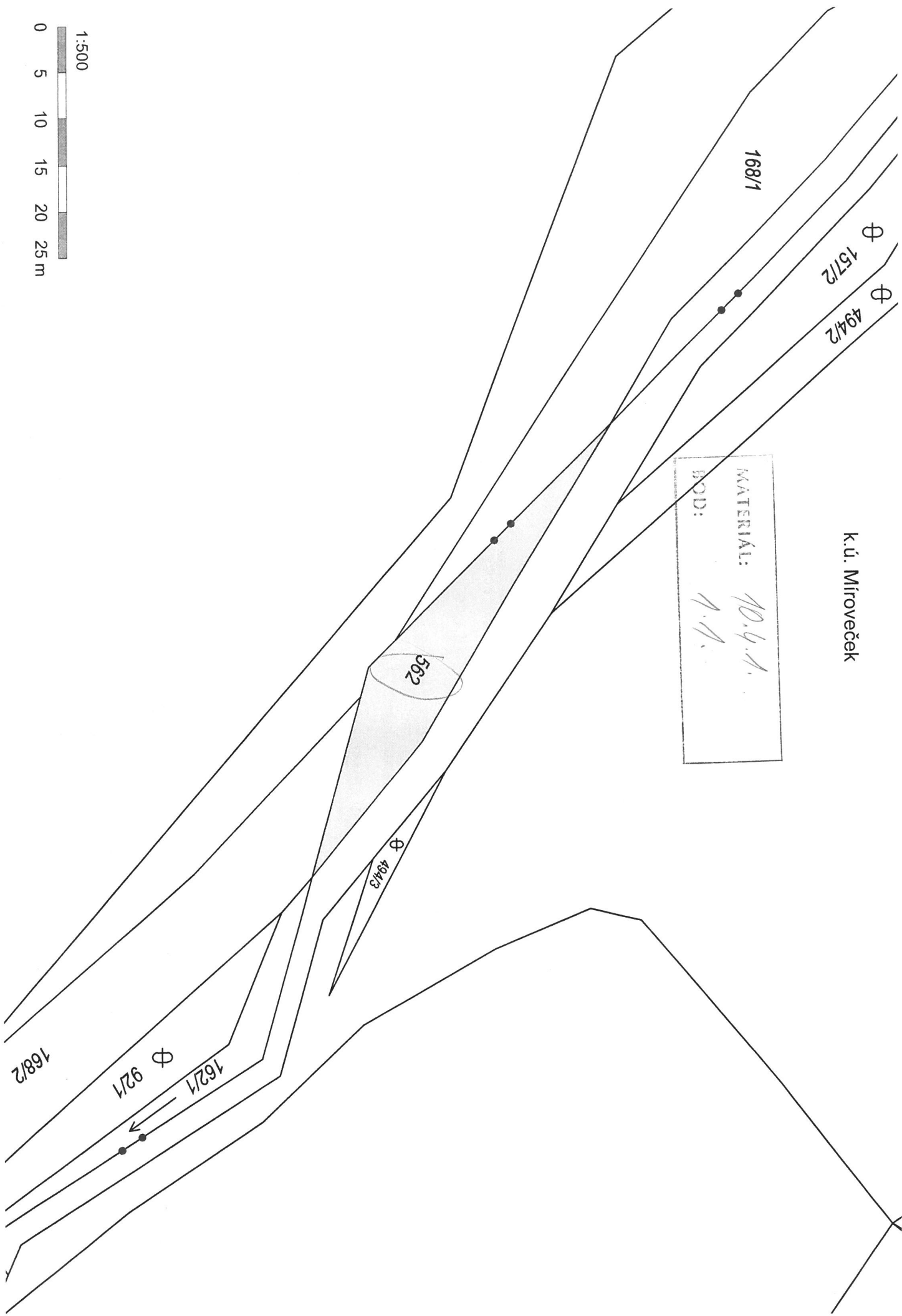

1:500
0 5 10 15 20 25 m

k.ú. Rejhořice

MAPA: 10.4.1
LOD: 1:2

366

21

212

850/2

1674/3

790/2

156/38

832/3

700/1

160

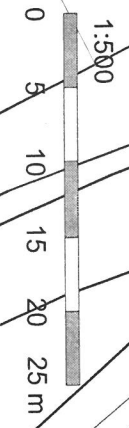

699

K.ú. Neředín

MATERIÁL: 104.1.
BOD: 1.2.

645/19

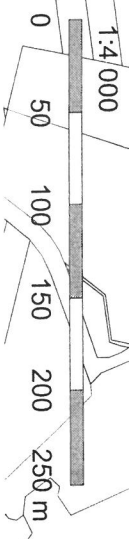

Л.В. БУДА ИВД НОЯБРЬ
МАТЕРИАЛ: №. 4.1.
БДД: 4.4.

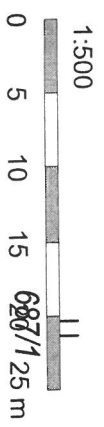
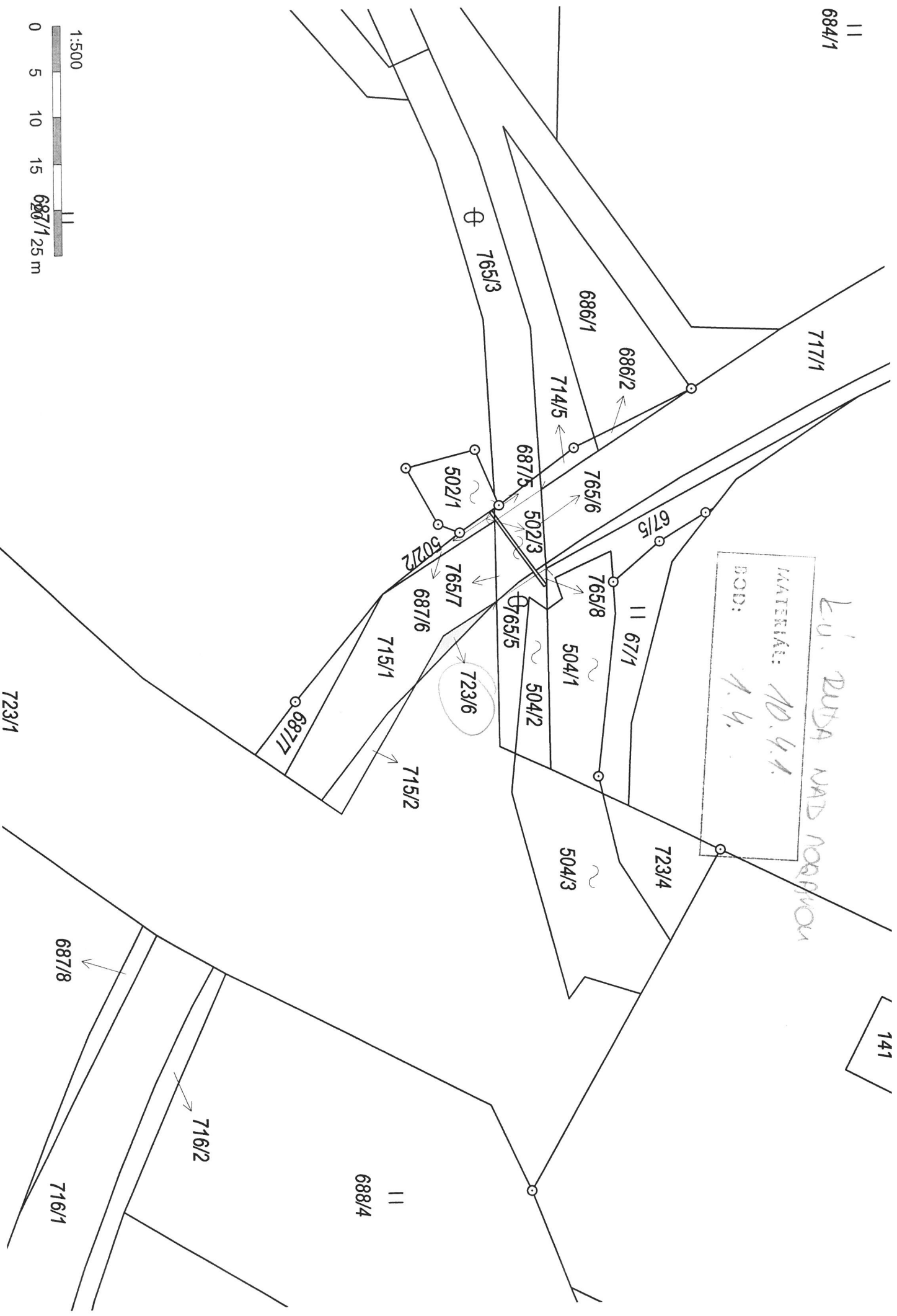

141

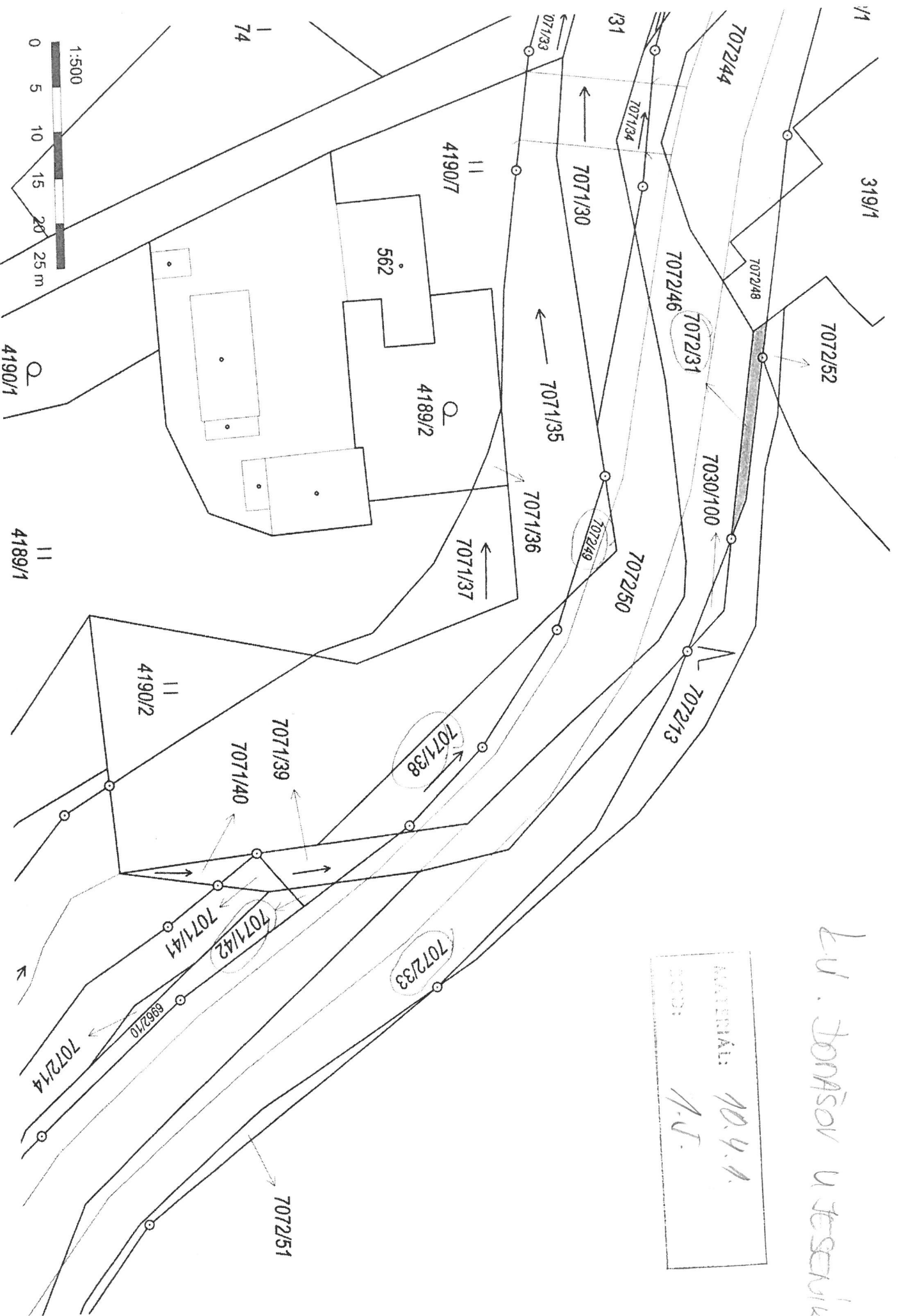

kv. Domašov u Těsčovic

MATERIÁL:	<i>MD.Y.A.</i>
ČÍSLO:	<i>A.J.</i>

VÝKAZ DOSAVADNHO A NOVEHO STAVU ÚDAJŮ KATASTRU NEMOVITOSTI										
Nový stav										
Číslo katastrální území	Výměra pozemku podle ÚP	Druh pozemku	Druh pozemku podle ÚP	Výměra pozemku podle ÚP	Druh pozemku podle ÚP	Typ stavby	ZAM	Zastavěná plocha		Výměra pozemku podle ÚP
								podle ÚP	podle ÚP	
185	1 56 12	185/2	185/2	1 53 06	185/2	1 00	0	185	185	1 53 06
		185/3	185/3	1 26	185/3	0	0	185	185	1 26

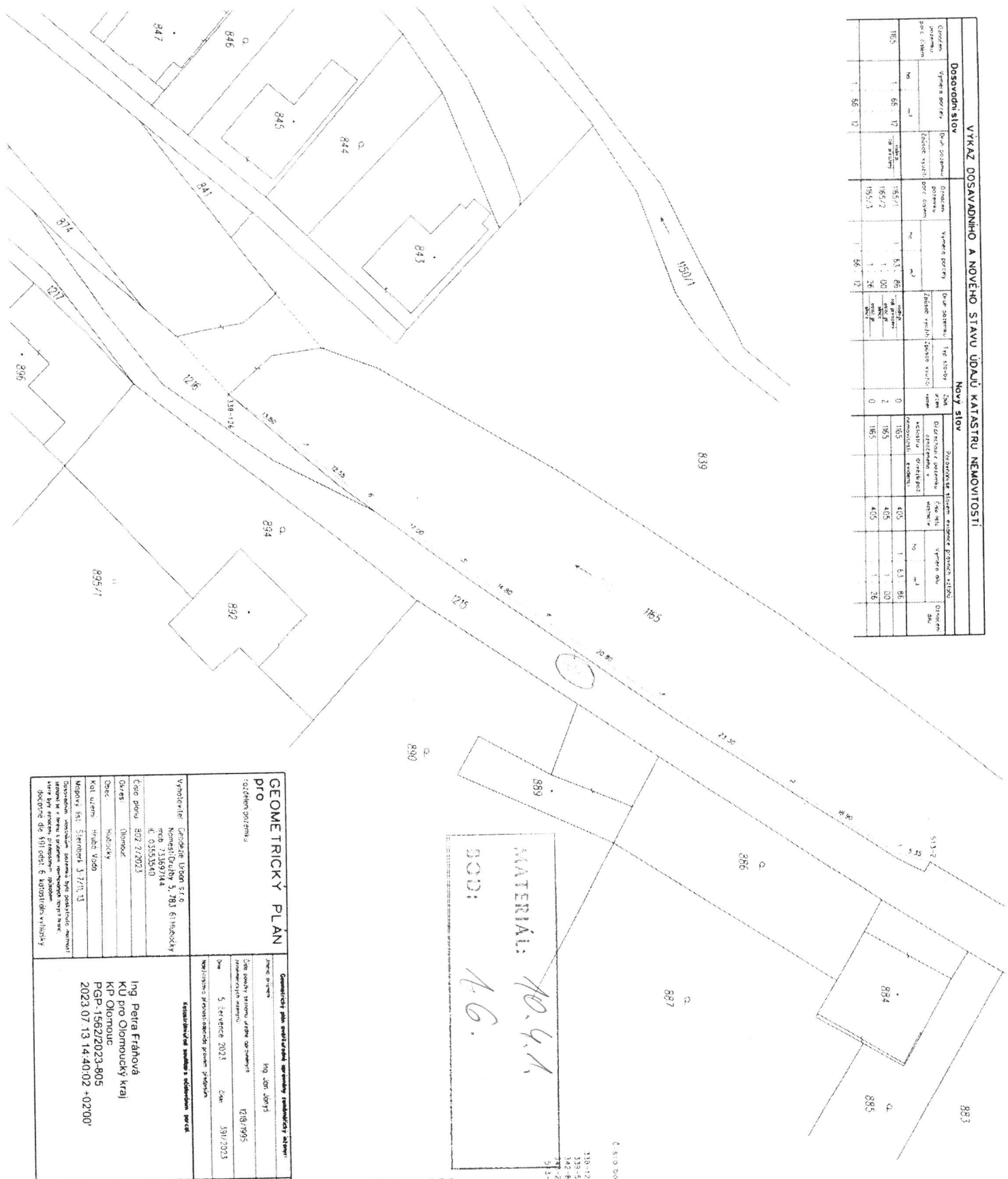

MATERIÁL:
NO. 4. A.
BOD:

Číslo pozemku	Výměra pozemku podle ÚP	Výměra pozemku podle ÚP	Výměra pozemku podle ÚP	Výměra pozemku podle ÚP	Výměra pozemku podle ÚP
110-126	534496,24	1134894,83	3	185/1	185/1
338-26	534499,13	1134829,46	3	185/2	185/2
342-43	534502,13	1134814,03	3	185/3	185/3
342-44	534505,13	1134829,46	3	185/4	185/4
342-45	534508,13	1134844,89	3	185/5	185/5
342-46	534511,13	1134860,32	3	185/6	185/6
342-47	534514,13	1134875,75	3	185/7	185/7
342-48	534517,13	1134891,18	3	185/8	185/8
342-49	534520,13	1134906,61	3	185/9	185/9
342-50	534523,13	1134922,04	3	185/10	185/10
342-51	534526,13	1134937,47	3	185/11	185/11
342-52	534529,13	1134952,90	3	185/12	185/12
342-53	534532,13	1134968,33	3	185/13	185/13
342-54	534535,13	1134983,76	3	185/14	185/14
342-55	534538,13	1135000,00	3	185/15	185/15
342-56	534541,13	1135016,24	3	185/16	185/16
342-57	534544,13	1135032,48	3	185/17	185/17
342-58	534547,13	1135048,72	3	185/18	185/18
342-59	534550,13	1135065,00	3	185/19	185/19
342-60	534553,13	1135081,24	3	185/20	185/20
342-61	534556,13	1135097,48	3	185/21	185/21
342-62	534559,13	1135113,72	3	185/22	185/22
342-63	534562,13	1135130,00	3	185/23	185/23
342-64	534565,13	1135146,24	3	185/24	185/24
342-65	534568,13	1135162,48	3	185/25	185/25
342-66	534571,13	1135178,72	3	185/26	185/26
342-67	534574,13	1135195,00	3	185/27	185/27
342-68	534577,13	1135211,24	3	185/28	185/28
342-69	534580,13	1135227,48	3	185/29	185/29
342-70	534583,13	1135243,72	3	185/30	185/30
342-71	534586,13	1135260,00	3	185/31	185/31
342-72	534589,13	1135276,24	3	185/32	185/32
342-73	534592,13	1135292,48	3	185/33	185/33
342-74	534595,13	1135308,72	3	185/34	185/34
342-75	534598,13	1135325,00	3	185/35	185/35
342-76	534601,13	1135341,24	3	185/36	185/36
342-77	534604,13	1135357,48	3	185/37	185/37
342-78	534607,13	1135373,72	3	185/38	185/38
342-79	534610,13	1135390,00	3	185/39	185/39
342-80	534613,13	1135406,24	3	185/40	185/40
342-81	534616,13	1135422,48	3	185/41	185/41
342-82	534619,13	1135438,72	3	185/42	185/42
342-83	534622,13	1135455,00	3	185/43	185/43
342-84	534625,13	1135471,24	3	185/44	185/44
342-85	534628,13	1135487,48	3	185/45	185/45
342-86	534631,13	1135503,72	3	185/46	185/46
342-87	534634,13	1135520,00	3	185/47	185/47
342-88	534637,13	1135536,24	3	185/48	185/48
342-89	534640,13	1135552,48	3	185/49	185/49
342-90	534643,13	1135568,72	3	185/50	185/50
342-91	534646,13	1135585,00	3	185/51	185/51
342-92	534649,13	1135601,24	3	185/52	185/52
342-93	534652,13	1135617,48	3	185/53	185/53
342-94	534655,13	1135633,72	3	185/54	185/54
342-95	534658,13	1135650,00	3	185/55	185/55
342-96	534661,13	1135666,24	3	185/56	185/56
342-97	534664,13	1135682,48	3	185/57	185/57
342-98	534667,13	1135698,72	3	185/58	185/58
342-99	534670,13	1135715,00	3	185/59	185/59
342-100	534673,13	1135731,24	3	185/60	185/60

GEOMETRICKÝ PLÁN
PFO
1:2000

Výnosové číslo: 2/2023
Datum: 2023.07.13

Ing. Petra Fraňková
KÚ pro Olomoucký kraj
PGP-1562/2023-805
2023.07.13 14:40:02 +02:00

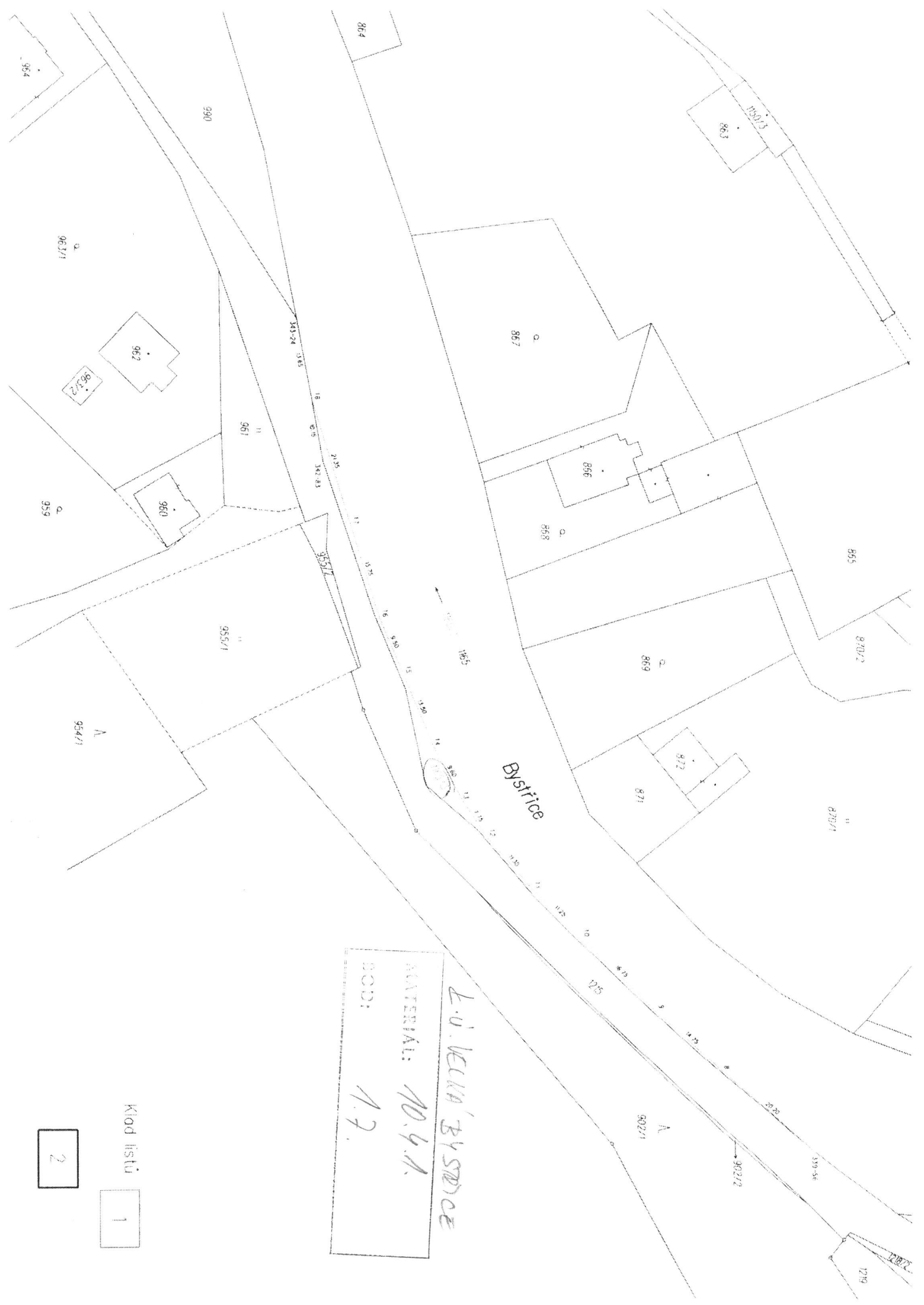

L. V. VELLA 'BYSTRICE
 MATERIÁL: 10. 4. 1.
 DOD: 1. 7.

Klód listu

1

2

E.V. VELKÁ BYSTŘICE

MATERIÁL: 10.4.1.

SOB: 1.2.

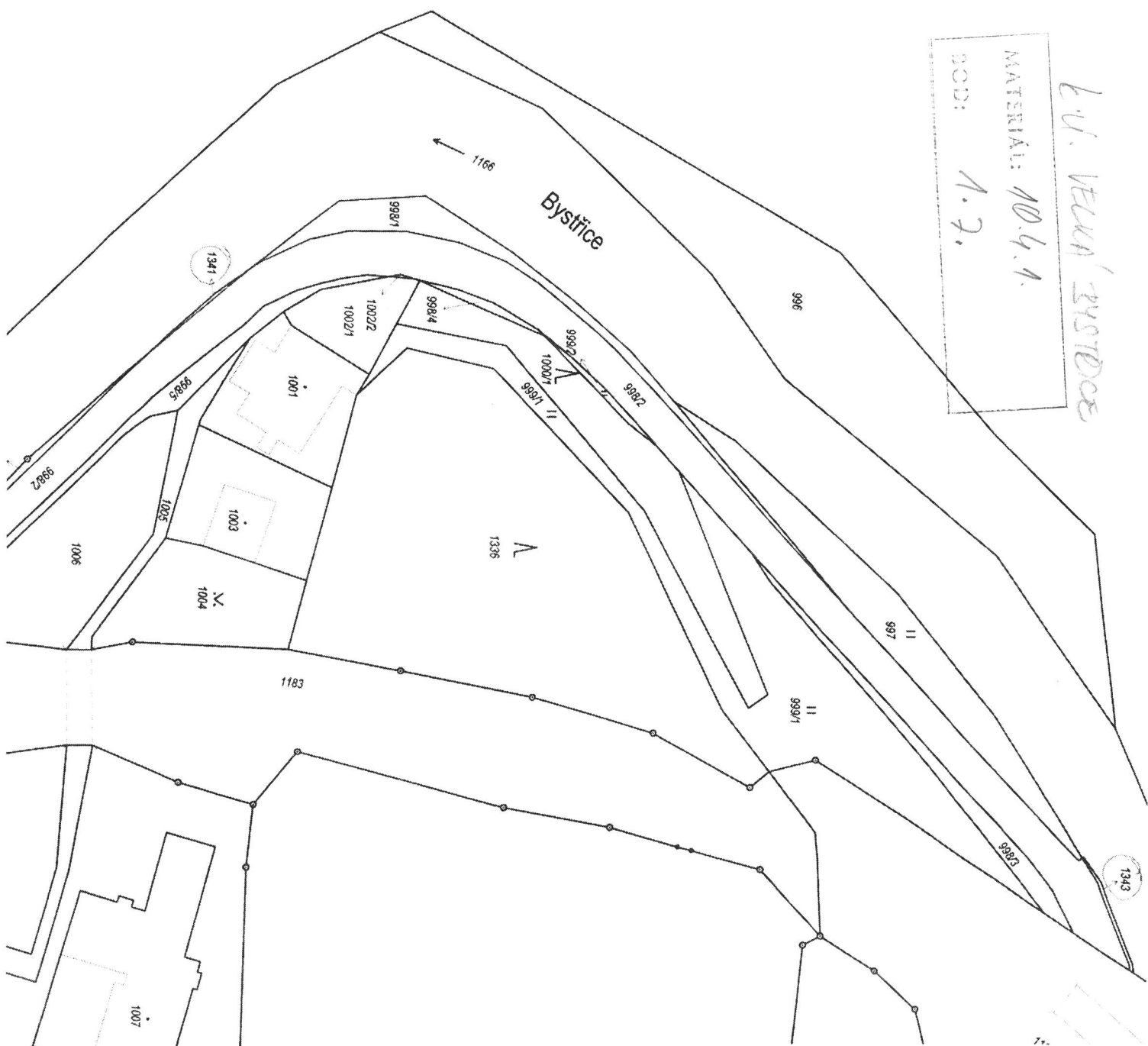

K.ú. Velká Bystřice

BYSTŘICE
K.ú. Velká Bystřice
800:
19.11.1991

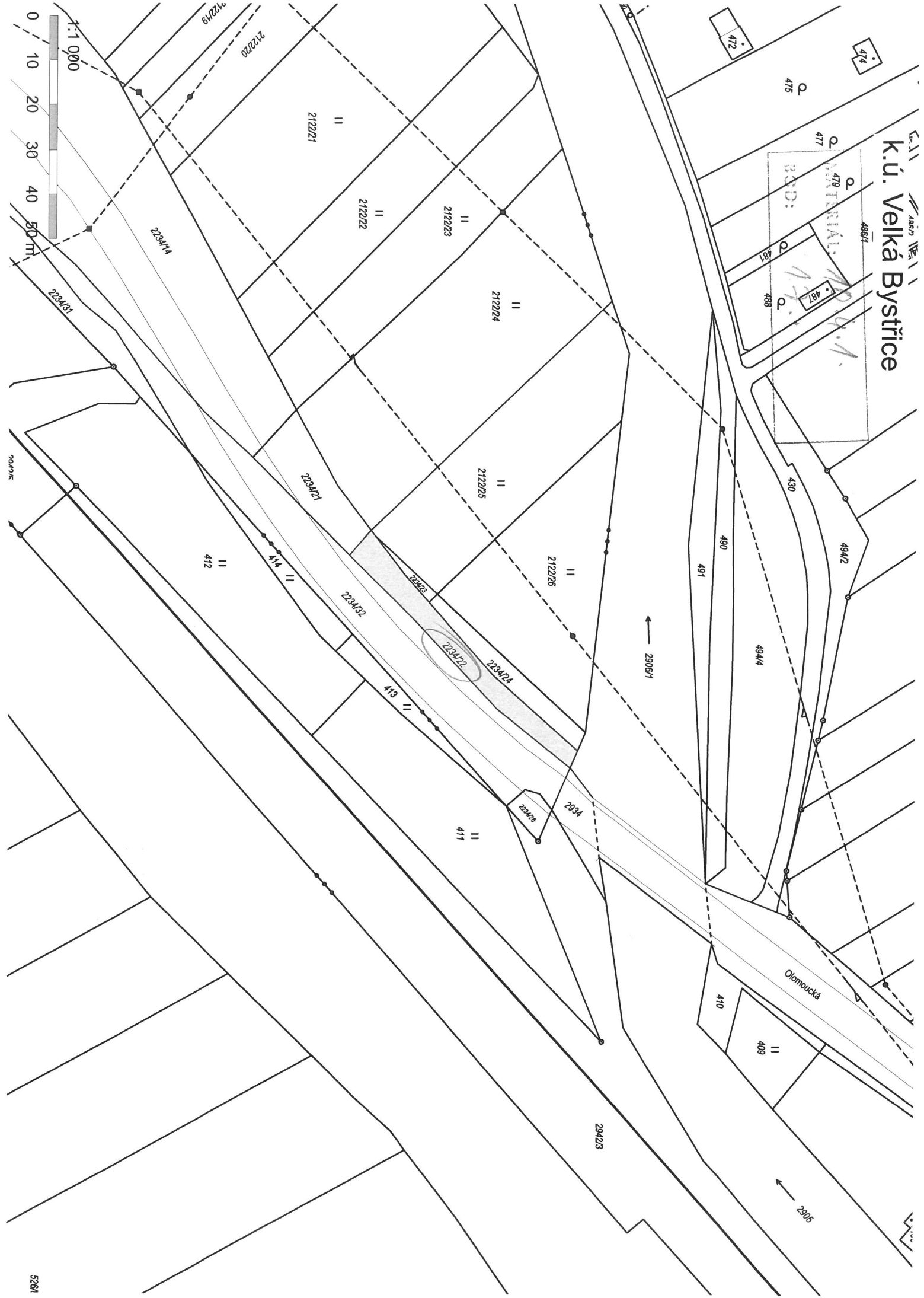

K.ú. Liboš

MATEŘNÍ: 10. 4. 1.
BOD: 1. 8.

387/1

453/2

453/3

450/4

443/30

443/29

367

366

364

3

1:250

0 2 4 6 8 10 m

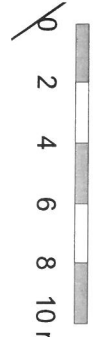

k.ú. Nasobůrky

326

MATERIK:
10.4.1.
BOD: 1.9.

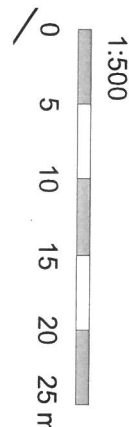

187/10

253/25

44/5

253/26

187/16



44/8

44/7

307/6

253/17

46/7

46/6

47/12

44/6

47/11

43

253/21

253/18

46/5

46/4

253/19

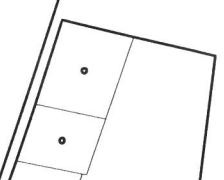

K.ú. Velké Losiny

MAJITEL: M.Č.Č.
BOD: A.10.



1:1 000
0 10 20 30 40 50 m

2719/5 Bukovická

2719/4

1783/4

1917/1

1881/8

1881/39

1881/9

1881/32

1925/4

K.ú. Hustopeče nad Bečvou

MATEŘKA: *M. V. A.*
BOD: *A. M.*

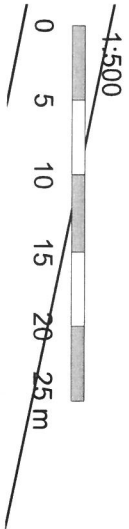

961/76

960

884/143

122/15

122/14

452/2

122/8

1245/2

452/1

394

Školní

395

11
388

Q 399

398

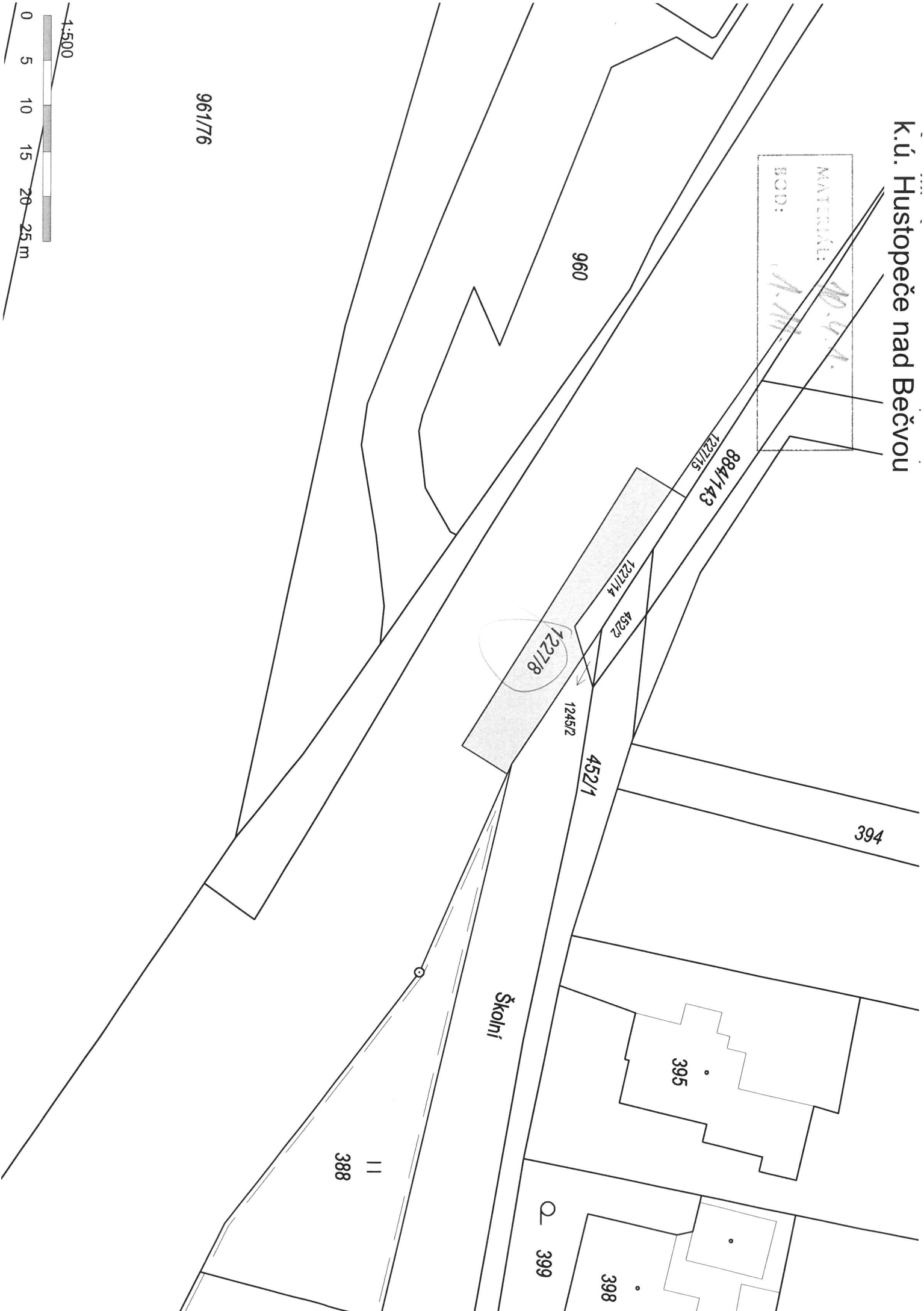

K.ú. Hustopeče nad Bečvou

MATEŘKA: *NO. 4. A.*
BOD: *A. 11.*

11:

1227/13

1227/12

1131/1

1:500

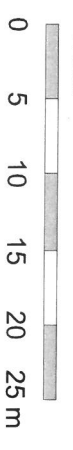

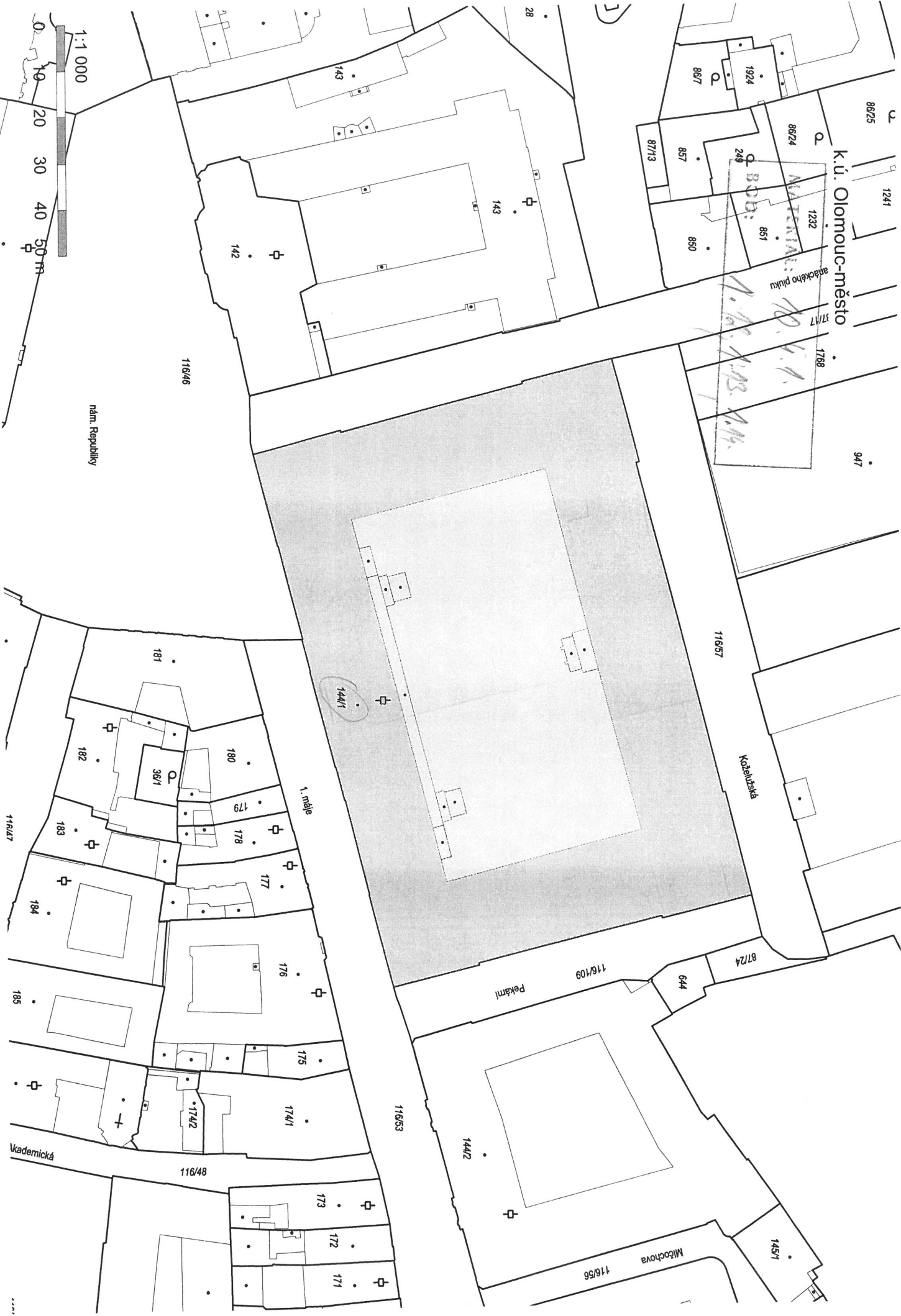

K.ú. Olomouc-město

1232
MATEŘINA:
249
BOB:
851
850
857
867
87/13
8824
1924

Handwritten notes:
N. P. X. P. B.
P. M.

Košutčanská

Pekáři

Míčovova

Vademická

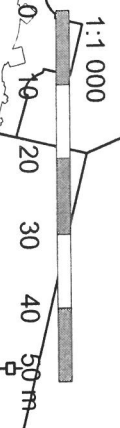

nam. Republiky

118/46

116/48

1. město

118/53

118/57

116/109

144/2

173

172

171

174/1

176

177

178

179

180

181

38/1

182

183

194

195

145/1

644

87/24

K. U. CHVALKOVICE

MATERIÁL: 10.4.1.
BOD: 1.15.

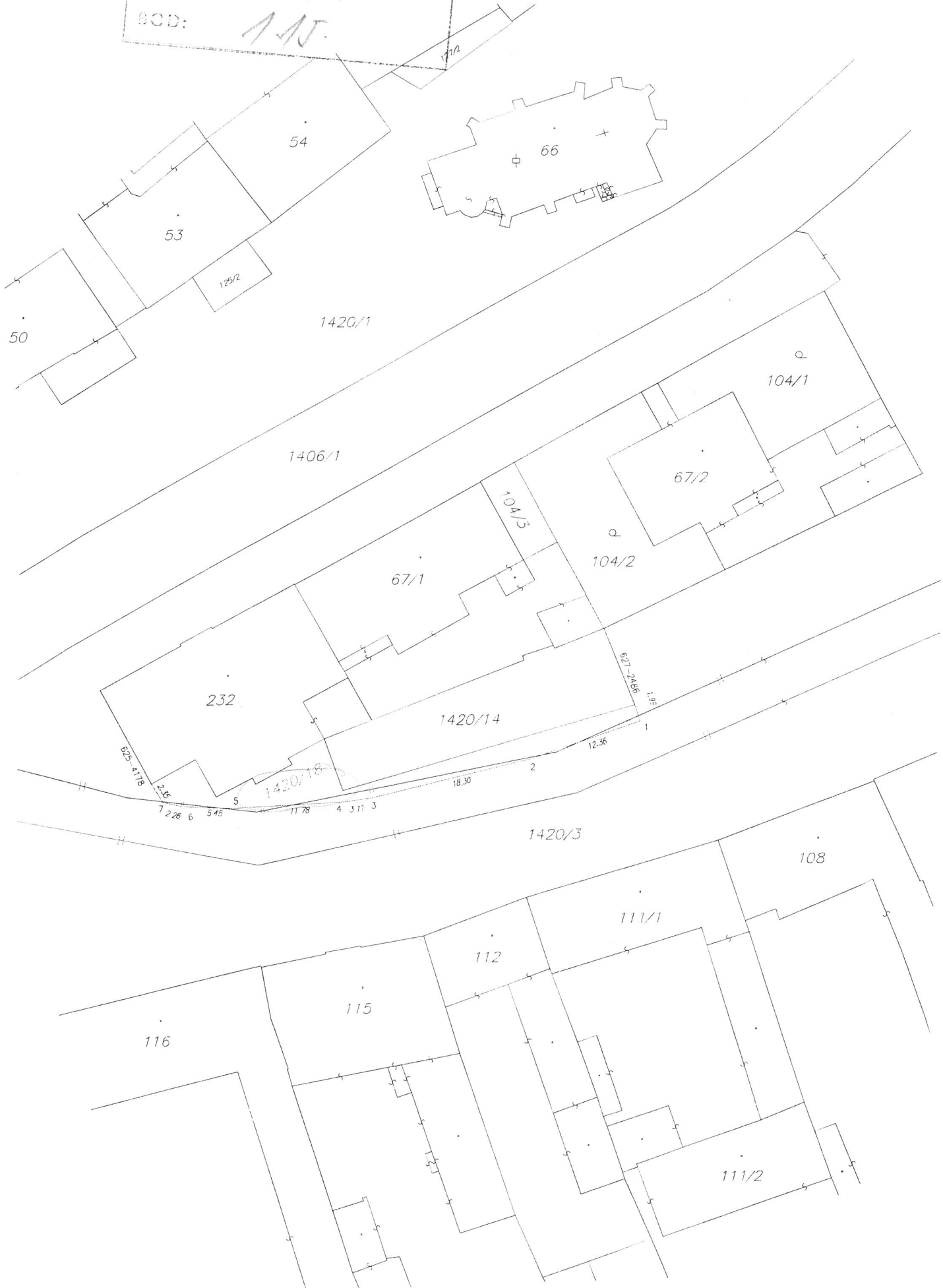

K.ú. Jezernice

1184/61

CONTENIDA: *10.4.1.*
JOB: *2.1.1.*

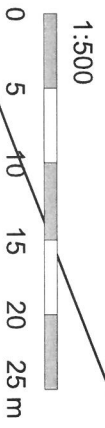
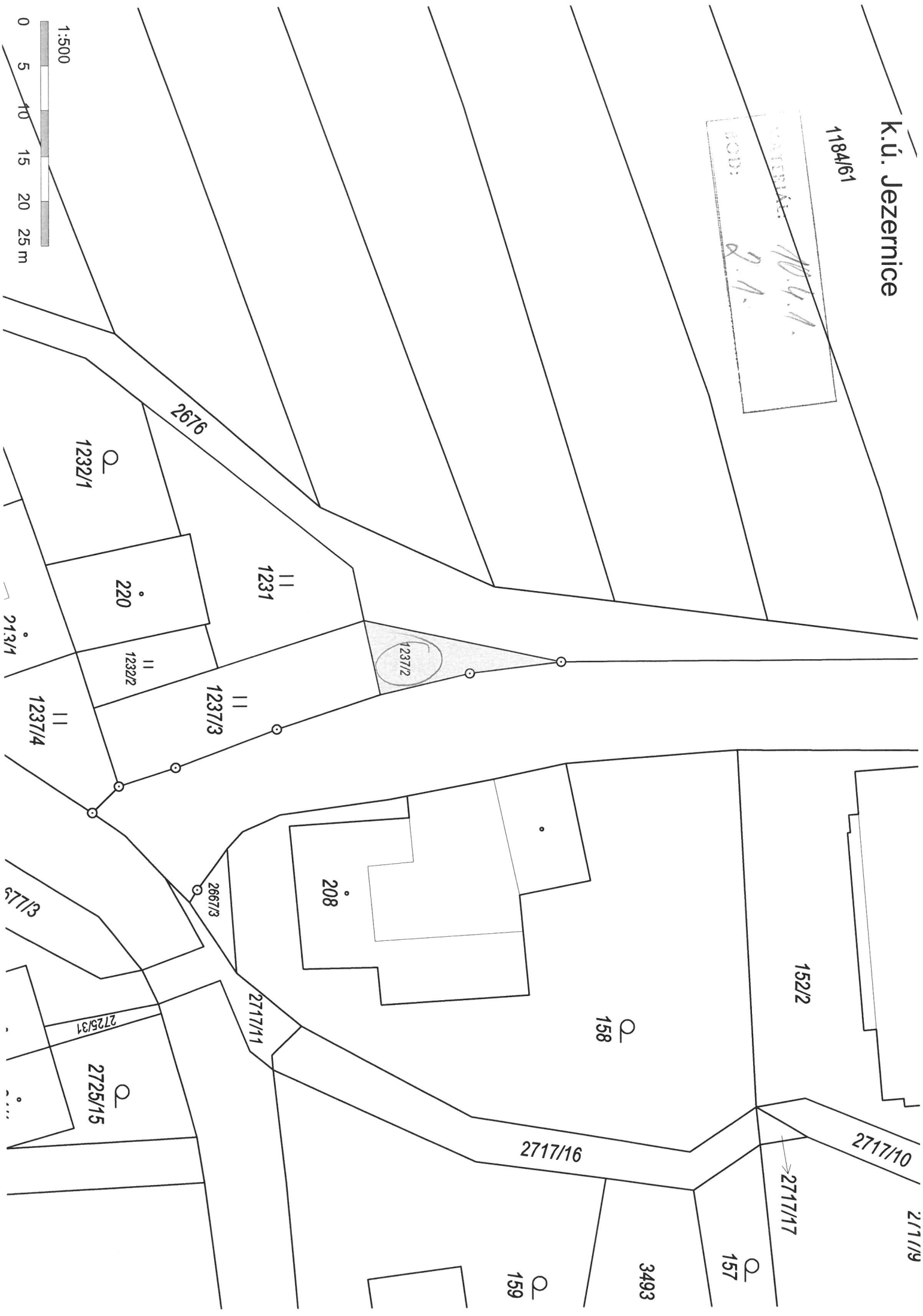

213/1

277/3

2725/31

2717/9

K.ú. Obectov

MATERIÁL: 10.4.1.
BOD: 2.8.

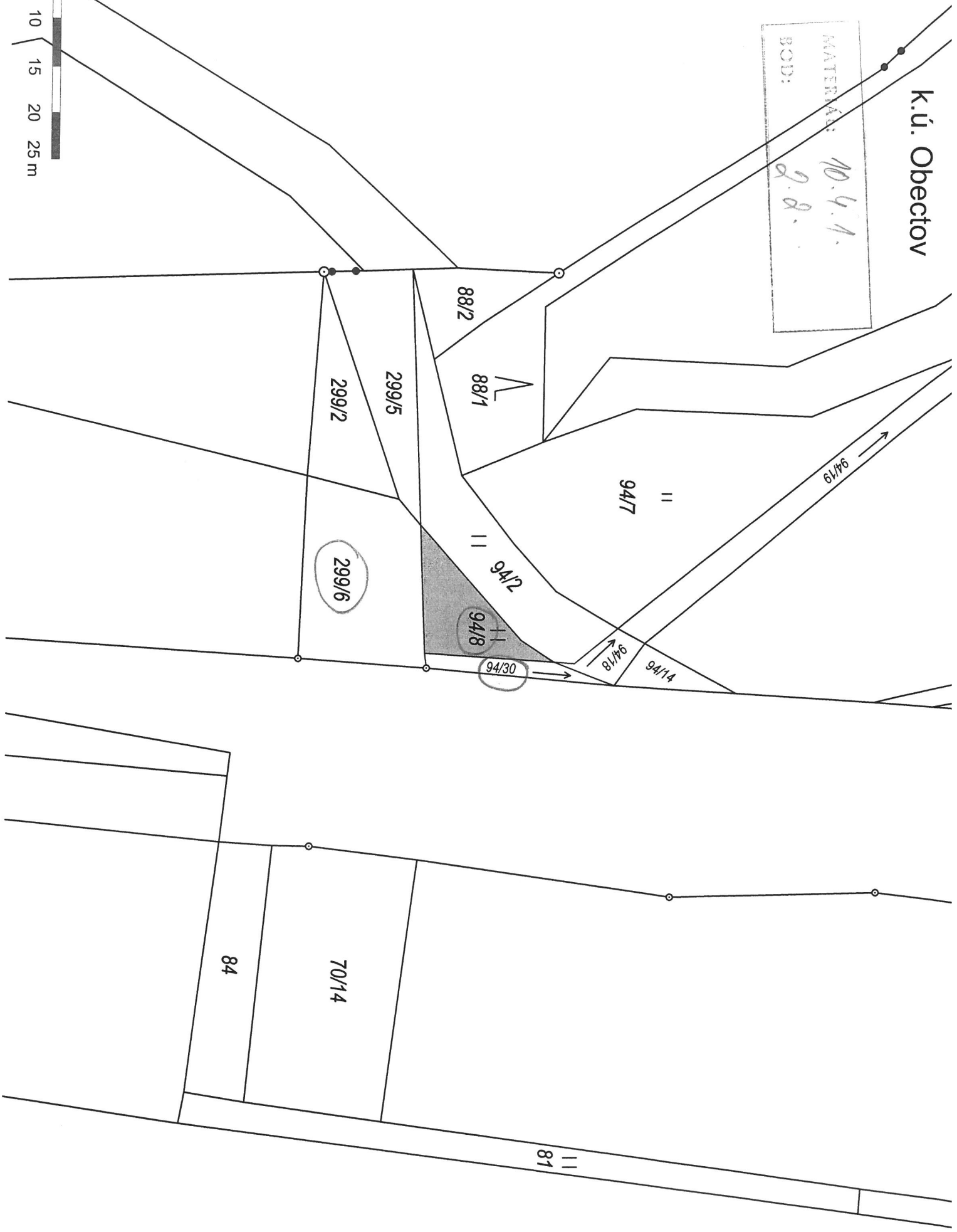
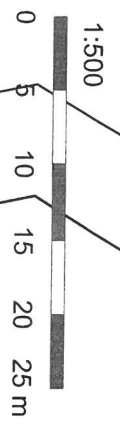

k.ú. Lutín

MAĽPIS:

10:5.1.

ROD:

2.3.

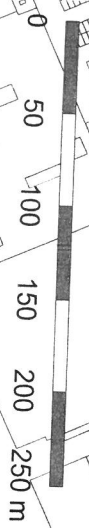

1:4000



K.ú. Stínava

MATERIÁL: *10.4.1.*
BOD: *2.4.1.*

1068/3

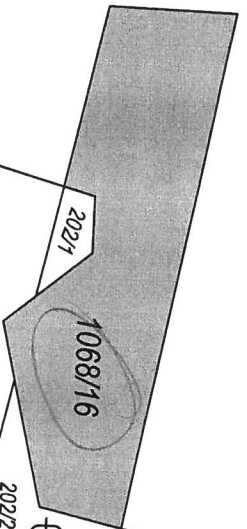

202/2

203

204

205

206

207

186/1

102

186/2

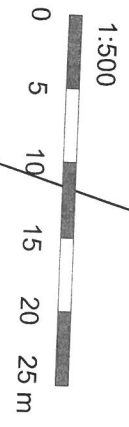

66/2

k.ú. Veselíčko

Č. ÚZEMNÍHO PLÁNU: 10.4.1.
BOD: 2.50

11
67

157/4

6

24

8
22

24

68/2

164

5/2

5/4

28

17/2

17/1

3/1

3/2

2/1

3/1

3/2

22/1

22/2

5/1

5/5

18

149/1

70/3

79/5

7/4

7/5

